

This drawing is the copyright of Roberts Limbrick Ltd and should not be reproduced in whole or in part or used in any manner whatsoever without their written permission.

Do Not scale off this drawing, use only figured dimensions and report any discrepancies or omissions to the Architect immediately.

Rev.	Date	Description
A	17.03.2020	Issued Site Plan
B	19.03.2020	Rev B Plans
C	20.03.20	Revision C Plans
D	24.03.2020	Title block amended. Drawing extend to the Southern boundary increased to include houses.
E	31.03.2020	Site plan coloured.
F	02.04.2020	Drawing number changed from L101010. Revision to GF plant room internal layout and external footprint.
G	06.10.2020	Revised South Car Park and updated North Car Park to suite Hydrock drawings.
H	07.10.2020	Ground Floor Plan shown on site plan
J	12.10.2020	Updated footpath
K	10.11.2020	Updated fencing to substation and middle car park area
L	25.03.2021	ISSUED FOR PLANNING
M	01.04.2021	ISSUED FOR PLANNING
N	14.04.2021	ISSUED FOR PLANNING
P	27.04.2021	ISSUED FOR PLANNING
Q	04.08.2021	ISSUED FOR APPROVAL
R	05.08.2021	ISSUED FOR APPROVAL
S	16.08.2021	ISSUED FOR APPROVAL
T	25.08.2021	ISSUED FOR APPROVAL
U	14.09.2021	ISSUED FOR APPROVAL
V	17.09.2021	ISSUED FOR APPROVAL - General Site Plan Update
W	22.09.2021	ISSUED FOR APPROVAL
X	30.09.2021	ISSUED FOR APPROVAL
Y	19.10.2021	ISSUED FOR PLANNING
Z	04.01.2022	ISSUED FOR PLANNING
AA	21.01.2022	ISSUED FOR PLANNING

**KEY**

- Planning / work associated boundary
- Existing public rights of way (approx. legal line)
- MELK 20 public right of way (approx. legal line)

**MH** Melksham House Listed Grade II

**D** Existing pond

**H** Tennis courts

**I** Car parking

**J** Cricket pavilion

**K** Cricket square

**L** Bowls green and pavilion

**M** Blue Pool Site

**N** Principal site entrance (vehicles / pedestrians)

**O** Melksham Campus

**R** Cemetery extension

**W** Well

Demolitions

Fire Hydrants

Wheelstops

Potential locations for parking meters subject to the parking strategy

**Roberts Limbrick**  
ARCHITECTS

PROJECT  
Melksham Community Campus

CLIENT  
Wiltshire Council

DRAWING  
Proposed Site Plan

STATUS  
PLANNING

**ROBERTS LIMBRICK LTD**  
The Carriage Building, Bruton Way  
Gloucester, GL1 1DG  
The Estates Office 25 - 26 Gold Tops  
Newport, NP20 4PG  
T. 03333 405 500  
mail@robertslimbrick.com  
www.robertslimbrick.com

Registered Office: England No. 06558029  
SCALE 1:500@A1  
DATE 15/01/20  
ORIGINATOR NO 9644  
AUTHOR SL

DRAWING NUMBER: 002-61505-RLL-XX-01-DR-A-L(9)010AA  
REVISION

**Notes**

- Proposed Car park provision: 201 total made up of; 166 general spaces + 17 accessible spaces + 12 family spaces + 6 electric car charging bays + 2 additional coach parking spaces.
- Refer to EML and Hydrock drawings for Soft / hard landscaping proposals.

**Notes**

All site information based on survey information provided by Brunel surveys in Oct, 2011 and updated on Nov, 2018.

Ordnance survey information provided by Ordnance Survey © Crown copyright 2011. All right reserved. Licence number 100020449.

**ORCHARD GARDENS**

21/01/2022 13:50:24



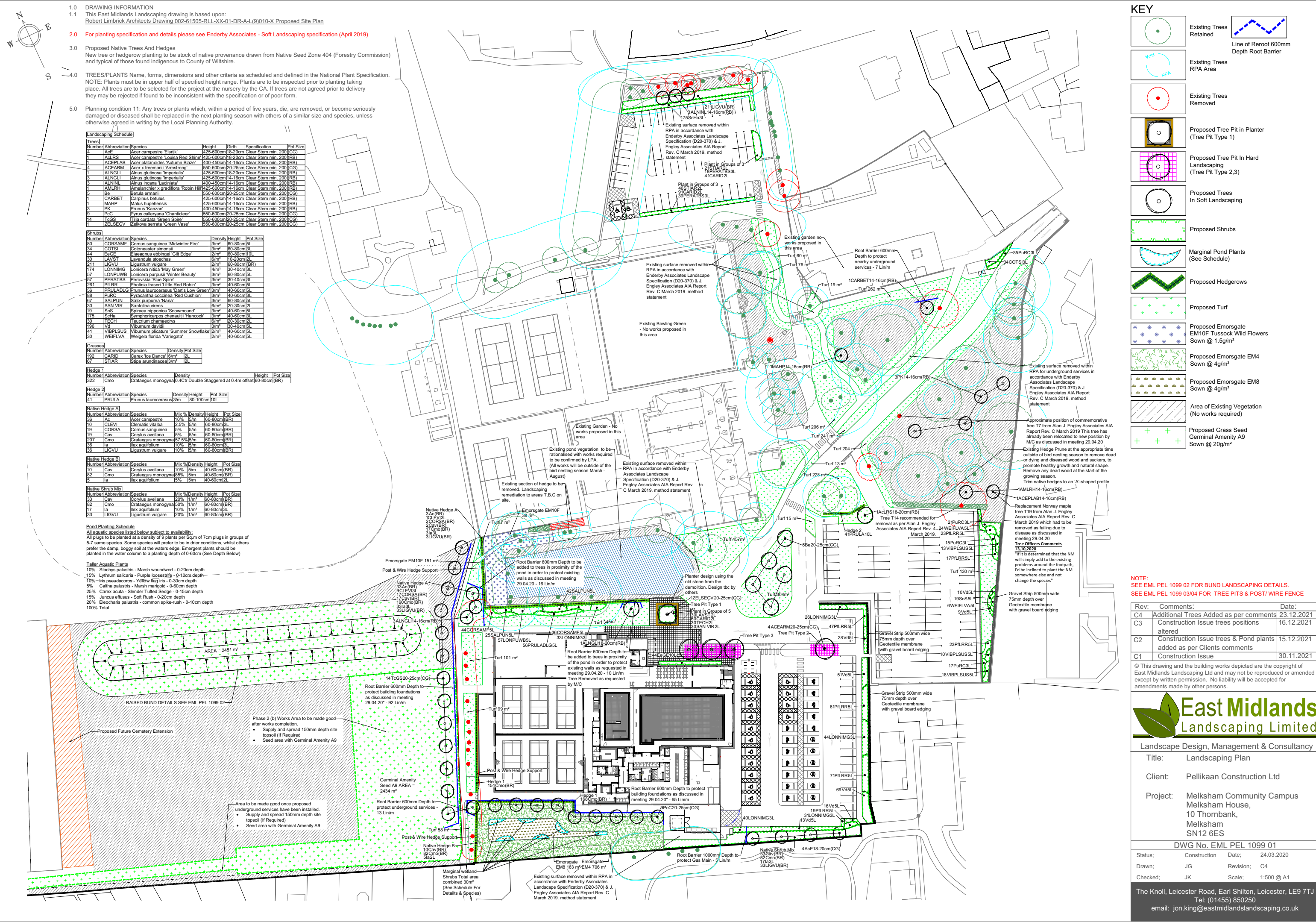

- 1.0 DRAWING INFORMATION  
1.1 This East Midlands Landscaping drawing is based upon:  
Robert Limbrick Architects Drawing 002-61505-RL-XX-01-DR-A-L(9)010-X Proposed Site Plan
- 2.0 For planting specification and details please see Enderby Associates - Soft Landscaping specification (April 2019)
- 3.0 Proposed Native Trees And Hedges  
New tree or hedgerow planting to be stock of native provenance drawn from Native Seed Zone 404 (Forestry Commission) and typical of those found indigenous to County of Wiltshire.
- 4.0 TREES/PLANTS Name, forms, dimensions and other criteria as scheduled and defined in the National Planting Specification.  
NOTE: Plants must be in upper half of specified height range. Plants are to be inspected prior to planting taking place. All trees are to be selected for the project at the nursery by the CA. If trees are not agreed prior to delivery they may be rejected if found to be inconsistent with the specification or of poor form.
- 5.0 Planning condition 11: Any trees or plants which, within a period of five years, die, are removed, or become seriously damaged or diseased shall be replaced in the next planting season with others of a similar size and species, unless otherwise agreed in writing by the Local Planning Authority.

Landscaping Schedule					
Tree	Number	Abbreviation	Species	Height	Pot Size
4	AcE	Acer campestre	'Eisrijk'	425-600cm	18-20cm
1	AcLRS	Acer campestre	Louisa Red Shine	425-600cm	18-20cm
1	ACEPLAB	Acer platanoides	'Autumn Blaze'	400-450cm	14-16cm
4	ACEARM	Acer x freemanii	'Armstrong'	550-600cm	20-25cm
1	ALNGLI	Alnus glutinosa	'Imperialis'	425-600cm	18-20cm
3	ALNGLI	Alnus glutinosa	'Imperialis'	425-600cm	14-16cm
1	ALNINI	Alnus incana	Laciniata	400-450cm	14-16cm
1	AMLRH	Amelanchier x grandiflora	'Robin Hill'	425-600cm	14-16cm
5	Be	Betula ermanii		550-600cm	20-25cm
1	CARBET	Carpinus betulus		425-600cm	14-16cm
1	MAHP	Malus hupehensis		425-600cm	14-16cm
3	PK	Prunus Karzan		400-450cm	14-16cm
9	PC	Pyrus calleryana	'Chanticleer'	550-600cm	20-25cm
14	TcGS	Tilia cordata	'Green Spire'	550-600cm	20-25cm
1	ZELSEGV	Zelkova serrata	'Green Vase'	550-600cm	20-25cm

Shrubs					
Number	Abbreviation	Species	Density	Height	Pot Size
80	CORSAMF	Cornus sanguinea	'Midwinter Fire'	3m	60-80cm
34	COTSL	Cotoneaster amomifolius		3m	60-80cm
44	EaGE	Elaeagnus ebbingei	'Gilt Edge'	2m	60-80cm
30	LAVST	Lavandula stoechas		2m	10-20cm
211	LIGVU	Ligustrum vulgare		2m	60-80cm
174	LONNIMG	Lonicera nitida	'May Green'	4m	30-40cm
57	LONPUWB	Lonicera purpurea	'Winter Beauty'	3m	60-80cm
67	PERATBS	Perovskia 'Blue Spire'		3m	30-40cm
261	PILRR	Photinia fraseri	'Little Red Robin'	3m	40-60cm
56	PRULADLG	Prunus laurocerasus	'Dart's Low Green'	3m	40-60cm
88	PURC	Pyracantha coccinea	'Red Cushion'	3m	40-60cm
67	SALPIN	Salix purpurea	'Nana'	3m	30-40cm
30	SAN VIR	Santolina virens		6m	20-30cm
19	SnS	Spiraea nipponica	'Snowmound'	3m	40-60cm
175	Sche	Symphoricarpos chenaultii	'Hancock'	3m	40-60cm
30	TECH	Teucrium chamaedrys		3m	20-30cm
196	Vd	Viburnum davidii		3m	30-40cm
41	VIBPLUS	Viburnum plicatum	'Summer Snowflake'	2m	40-60cm
30	WEFLVA	Weigela florida	'Variegata'	2m	40-60cm

Grasses					
Number	Abbreviation	Species	Density	Pot Size	
192	CARID	Carex 'Ice Dance'	16/m²	2L	
67	STIAR	Stipa arundinacea	3/m²	2L	

Hedge 1					
Number	Abbreviation	Species	Density	Height	Pot Size
622	Cmo	Crataegus monogyna	0.4c/v	Double Staggered at 0.4m offset	60-80cm (BR)

Hedge 2					
Number	Abbreviation	Species	Density	Height	Pot Size
41	PRULA	Prunus laurocerasus	3/m	80-100cm	10L

Native Hedge A					
Number	Abbreviation	Species	Mix %	Density	Pot Size
36	Ac	Acer campestre	10%	5/m	60-80cm (BR)
10	CLLEVI	Clematis vitalba	25%	5/m	60-80cm (BR)
19	CORSA	Cornus sanguinea	5%	5/m	60-80cm (BR)
19	Cav	Corylus avellana	5%	5/m	60-80cm (BR)
207	Cmo	Crataegus monogyna	57.5%	5/m	60-80cm (BR)
36	la	Ilex aquifolium	10%	5/m	60-80cm (BR)
36	LIGVU	Ligustrum vulgare	10%	5/m	60-80cm (BR)

Native Hedge B					
Number	Abbreviation	Species	Mix %	Density	Pot Size
10	Cav	Corylus avellana	10%	5/m	40-60cm (BR)
82	Cmo	Crataegus monogyna	85%	5/m	40-60cm (BR)
5	la	Ilex aquifolium	5%	5/m	40-60cm (2L)

Native Shrub Mix					
Number	Abbreviation	Species	Mix %	Density	Pot Size
33	Cav	Corylus avellana	20%	11/m²	60-80cm (BR)
82	Cmo	Crataegus monogyna	50%	11/m²	60-80cm (BR)
17	la	Ilex aquifolium	10%	11/m²	60-80cm (3L)
33	LIGVU	Ligustrum vulgare	20%	11/m²	60-80cm (BR)

**Pond Planting Schedule**  
All aquatic species listed below subject to availability.  
All plugs to be planted at a density of 9 plants per Sq.m of 7cm plugs in groups of 5-7 same species. Some species will prefer to be in drier conditions, whilst others prefer the damp, boggy soil at the waters edge. Emergent plants should be planted in the water column to a planting depth of 0-60cm (See Depth Below)

**Taller Aquatic Plants**  
10% Stachys palustris - Marsh woundwort - 0-20cm depth  
15% Lythrum salicaria - Purple loosestrife - 0-10cm depth  
10% Iris pseudocorus - Yellow flag iris - 0-30cm depth  
5% Caltha palustris - Marsh marigold - 0-60cm depth  
25% Carex acuta - Slender Tufted Sedge - 0-15cm depth  
15% Juncus effusus - Soft Rush - 0-20cm depth  
20% Eleocharis palustris - common spike-rush - 0-10cm depth  
100% Total

**KEY**

Existing Trees Retained

Existing Trees RPA Area

Existing Trees Removed

Proposed Tree Pit in Planter (Tree Pit Type 1)

Proposed Tree Pit in Hard Landscaping (Tree Pit Type 2,3)

Proposed Trees in Soft Landscaping

Proposed Shrubs

Marginal Pond Plants (See Schedule)

Proposed Hedgerows

Proposed Turf

Proposed Emorsgate EM10F Tussock Wild Flowers Sown @ 1.5g/m²

Proposed Emorsgate EM4 Sown @ 4g/m²

Proposed Emorsgate EM8 Sown @ 4g/m²

Area of Existing Vegetation (No works required)

Proposed Grass Seed Germinal Amenity A9 Sown @ 20g/m²

Line of Reroot 600mm Depth Root Barrier

**NOTE:**  
SEE EML PEL 1099 02 FOR BUND LANDSCAPING DETAILS.  
SEE EML PEL 1099 03/04 FOR TREE PITS & POST/ WIRE FENCE

Rev:	Comments:	Date:
C4	Additional Trees Added as per comments	23.12.2021
C3	Construction Issue trees positions altered	16.12.2021
C2	Construction Issue trees & Pond plants added as per Clients comments	15.12.2021
C1	Construction Issue	30.11.2021

© This drawing and the building works depicted are the copyright of East Midlands Landscaping Ltd and may not be reproduced or amended except by written permission. No liability will be accepted for amendments made by other persons.

**East Midlands Landscaping Limited**

Landscape Design, Management & Consultancy

Title: Landscaping Plan

Client: Pellikaan Construction Ltd

Project: Melksham Community Campus  
Melksham House,  
10 Thornbank,  
Melksham  
SN12 6ES

DWG No. EML PEL 1099 01

Status:	Construction	Date:	24.03.2020
Drawn:	JG	Revision:	C4
Checked:	JK	Scale:	1:500 @ A1

The Knoll, Leicester Road, Earl Shilton, Leicester, LE9 7JT  
Tel: (01455) 850250  
email: jon.king@eastmidlandslandscaping.co.uk



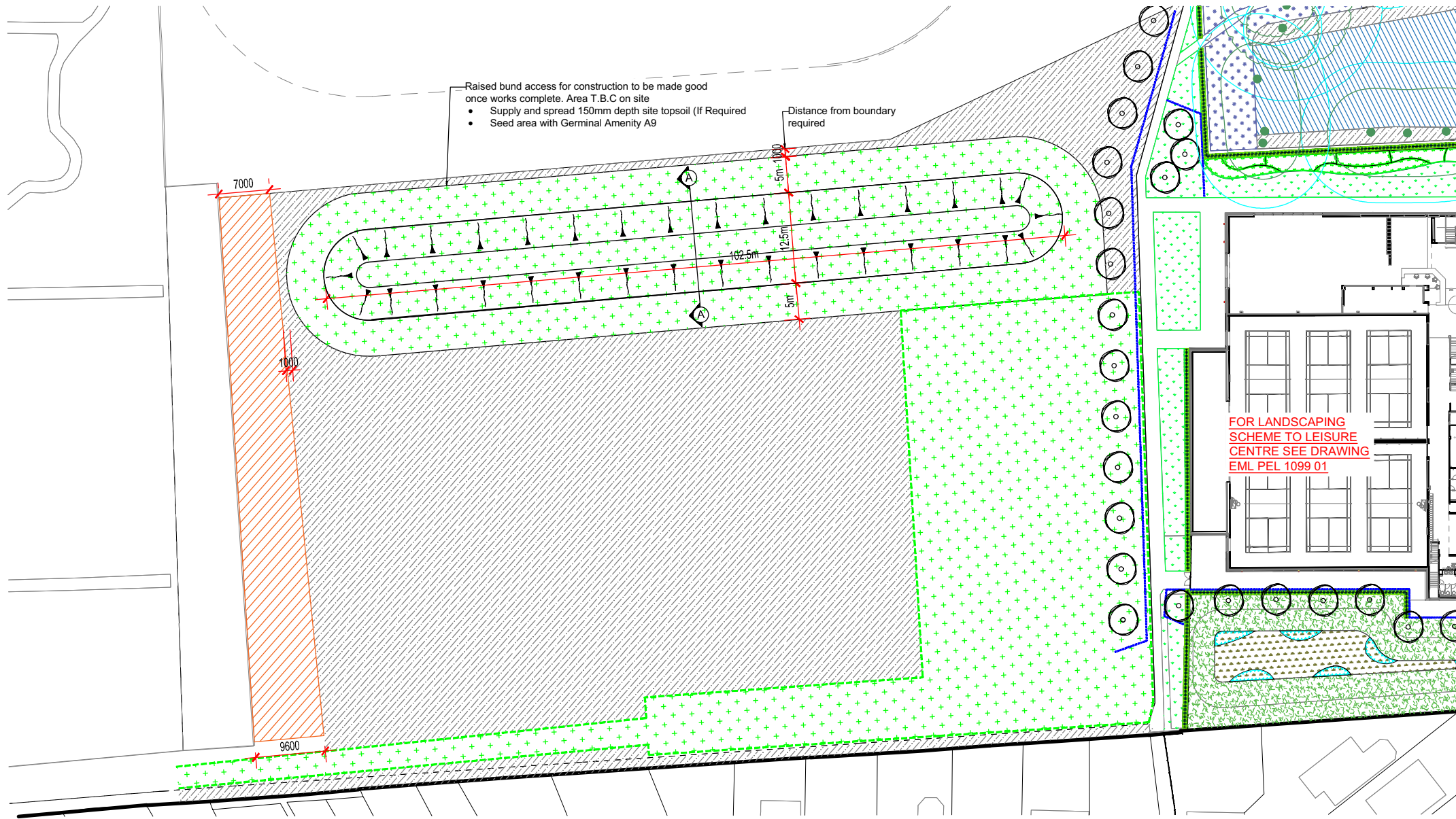
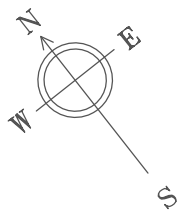

## KEY

- Existing Trees Retained
- Proposed Trees In Soft Landscaping (Tree Pit Type 2)
- Proposed Germinal Amenity A9 Sown @ 20g/m²
- Proposed Germinal Amenity A9 See Drawing [EML PEL 1099 01](#)
- Existing vegetation
- Area of Future Grave Yard Extension

### 1.0 DRAWING INFORMATION

- 1.1 This East Midlands Landscaping drawing is based upon: Robert Limbrick Architects  
Drawing: 002-61505-RLL-XX-01-DR-A-L(9)010-X Proposed Site Plan

### 2.0 LANDSCAPING SPECIFICATION

- Prior to construction of the mound existing topsoil shall be stripped from the base of the mound, (treated prior to stripping as per clauses 220 and 221 of Enderby Associates soft landscaping specification - April 2019).
- Mound slopes not to exceed 1:3
- Mound to be constructed from clean subsoil layed and consolidated in layers and slopes shall be evenly graded out into adjoining existing ground levels and the mound shall have a rounded toe and crest. **"It is very important on constructing soil layers that the subsoil is not compacted to avoid run-off and waterlogging around the base/toe of the mound"**.
- The mound should be constructed of upper horizons of site-won subsoil, avoiding the use of heavy clay (Refer to Ground Investigation report - Hydrock MLC-HYD-XX-GI-RP-G-1000 - 22 February 2019)
- Finished with a 150mm deep layer of topsoil BS:3882 2015 Specification
- Seeded with Germinal Amenity A18 @ 35g/m²

### 3.0 WATERING

- 3.1 All seeded areas will rely on natural germination & precipitation.

### 4.0 MAINTENANCE

- 4.1 Once seed has established to a height of 75mm cut to 50mm and remove cuttings from site.  
4.2 Allow minimum 4no. visits per annum

### RAISED BUND DETAIL SECTION A-A 1:50

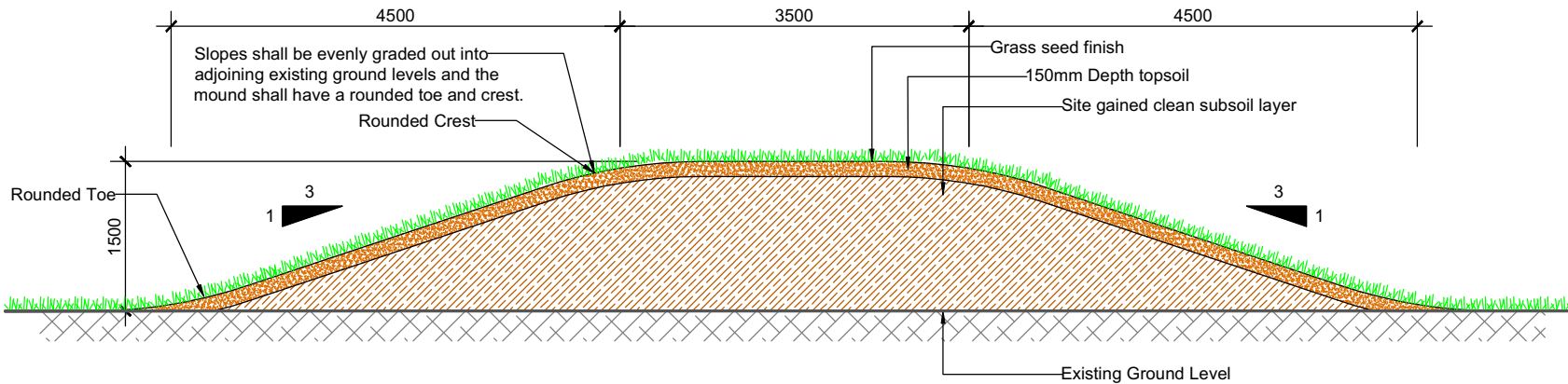

Rev:	Comments:	Date:
C1	Updated to show new trees	16.12.2021

© This drawing and the building works depicted are the copyright of East Midlands Landscaping Ltd and may not be reproduced or amended except by written permission. No liability will be accepted for amendments made by other persons.



Landscape Design, Management & Consultancy

Title:	Raised Bund Landscaping Plan
Client:	Pellikaan Construction Ltd
Project:	Melksham Community Campus Melksham House, 10 Thornbank, Melksham SN12 6ES

DWG No. EML PEL 1099 02

Status:	Construction	Date:	09.10.2020
Drawn:	JG	Revision:	C1
Checked:	JK	Scale:	See Drawing @ A2

The Knoll, Leicester Road, Earl Shilton, Leicester, LE9 7TJ  
Tel: (01455) 850250  
email: [jon.king@eastmidlandslandscaping.co.uk](mailto:jon.king@eastmidlandslandscaping.co.uk)

**TREE PIT TYPE 1  
PLANTER - SECTION  
CONCEPT DESIGN OPTION 2  
(SEE ROBERT LIMBRICK DRAWING  
61505-RL-LL-A-Sk210807-01  
FOR DETAILS)**

**TOTAL ROOTING VOLUME  
PER TREE 21m³**

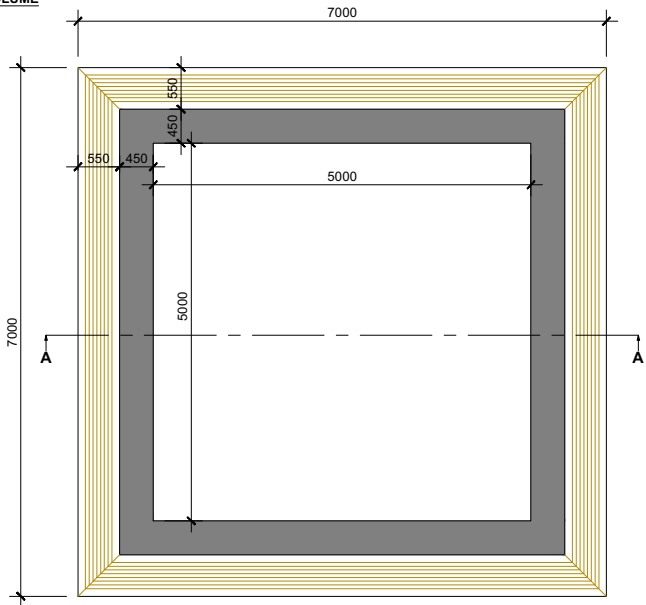

**TREE PIT TYPE 1  
PLANTER - SECTION  
CONCEPT DESIGN OPTION 2  
(SEE ROBERT LIMBRICK  
DRAWING  
61505-RL-LL-A-Sk210807-01  
FOR DETAILS)**

**TOTAL ROOTING VOLUME  
PER TREE 21m³**

Green Blue Urban Root Rain -  
Urban Irrigation System installed  
around the rootball. Ensure inlet  
is flush with or slightly above  
ground  
Stone Wall By Others  
Waterproof membrane to  
be included by stone wall  
designer  
Timber Seating By Others  
Paving By Others  
Sub soil to base of tree pit to be  
thoroughly broken up to depth of  
200mm prior to planting.  
Should base of tree pit be found to be  
water logged a 200mm gravel drainage  
layer should be installed.

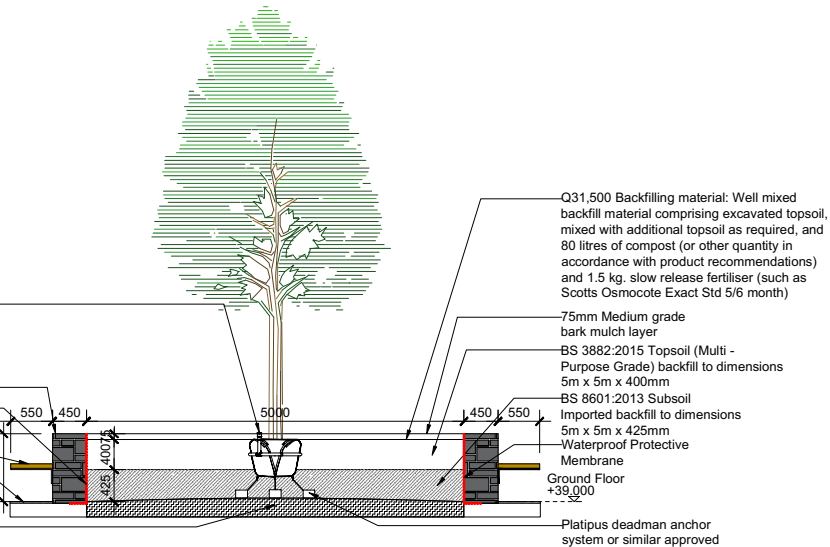

**TREE PIT TYPE 2  
HARD LANDSCAPING  
PLAN VIEW 1:50**

**TOTAL ROOTING VOLUME  
PER TREE 18.9m³**

RootSpace structure - 1 upright deep x  
18 uprights across x 7 uprights wide (1 x 2  
x 2 module void below root ball)  
Incorporate side panels to tree pit  
perimeter to increase strength loaded with  
Arborsoil Hydro C/W Airflow deck  
RRARBV150B Arborvent 150 single inlet  
aeration system with cast inlets  
fitted to RootSpace Airflow inlet.  
(An Aeration Manifold will need to be  
fitted to position the Root Space Airflow  
inlet in line with above paving design)

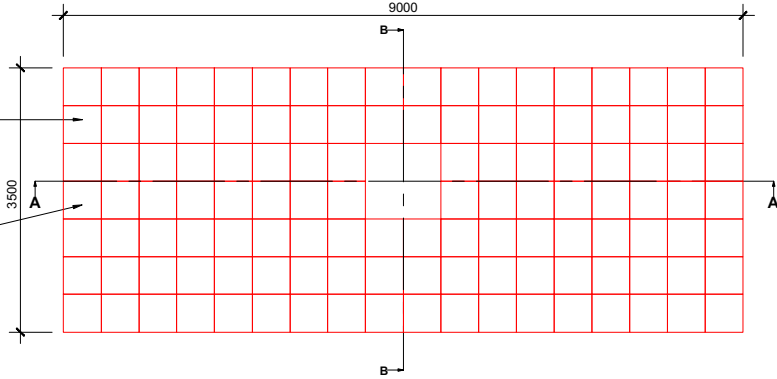

**TREE PIT TYPE 2 HARD  
LANDSCAPING  
SECTION AA VIEW 1:50**

**TOTAL ROOTING VOLUME PER  
TREE 18.9m³**

NOTE:  
Incorporate Rootstart Mycorrhiza - apply  
to tree pit at time of planting in  
accordance with manufacturers  
recommendations - allow 200g per tree.  
RD1000-RSA RootSpace RootDirector,  
medium, modular root barrier system  
Back filled with BS3882 sandy loam  
topsoil  
RRARBV150B Arborvent 150 single inlet  
aeration system with cast inlets  
fitted to RootSpace Airflow inlet.  
RootSpace structure - 1 upright deep x  
18 uprights across x 7 uprights wide  
(1 x 2 x 2 module void below  
RootDirector) loaded with BS3882  
Topsoil & RootStart Tree Fertiliser, c/w  
Airflow deck with side panels  
GRN20 plastic open reinforcing  
mesh, 20mm aperture laid below and  
around sides of RootSpace structure  
Additional twinwall GeoNet (GLTWGNA)  
to be installed where sub-base is installed  
below 3% CBR - Minimum 2%  
Drainage layer - minimum 200mm depth.  
Must be washed 10-20mm angular  
aggregate with no fines laid as flat as  
possible

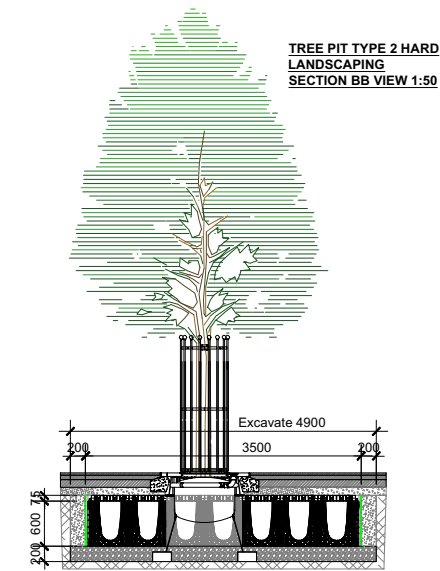
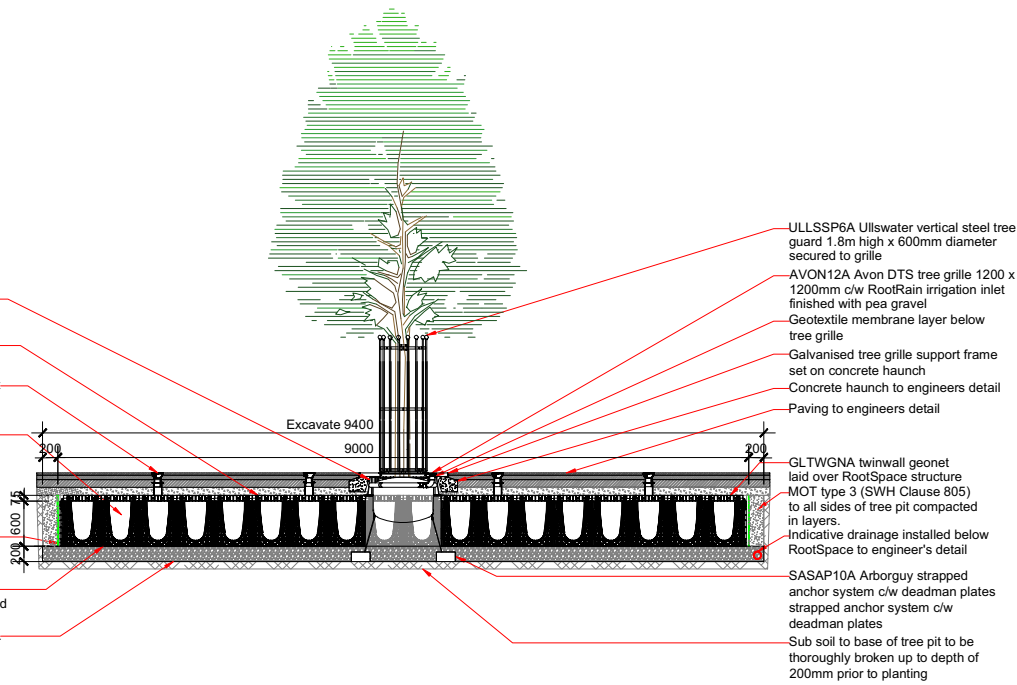

**NOTE:  
SEE EML PEL 1099 01 FOR LANDSCAPING  
DETAILS**

**TREE PIT DESIGNS TO BE CHECKED BY  
ENGINEERS FOR COMPLIANCE WITH  
WEIGHT LOADING REQUIREMENTS**

Rev:	Comments:	Date:
F	Construction change to planter	07.12.21
E	Construction Issue	30.11.21
D	Changed MOT specification	12.10.21
C	Changed as per latest comments	21.07.21
B	Changed as per latest comments	07.07.21
A	Changed as per latest comments	06.04.21

© This drawing and the building works depicted are the copyright of  
East Midlands Landscaping Ltd and may not be reproduced or amended  
except by written permission. No liability will be accepted for  
amendments made by other persons.



Landscape Design, Management & Consultancy

Title: Tree Pit Details  
Sheet 1 of 2  
Client: Pellikaan Construction Ltd  
Project: Melksham Community Campus  
Melksham House,  
10 Thornbank,  
Melksham  
SN12 6ES

DWG No. EML PEL 1099 03

Status;	Construction	Date;	17.11.2020
Drawn;	JG	Revision;	F
Checked;	JK	Scale;	1:50/1:20 @ A1

The Knoll, Leicester Road, Earl Shilton, Leicester, LE9 7TJ  
Tel: (01455) 850250  
email: jon.king@eastmidlandslandscaping.co.uk

TOTAL ROOTING VOLUME  
FOR LINEAR PIT 42m<sup>3</sup>

RRARBV150B Arborvent 150 single inlet-aeration system with cast inlets fitted to RootSpace Airflow inlet.  
(An Aeration Manifold will need to be fitted to position the Root Space Airflow inlet in line with above paving design)

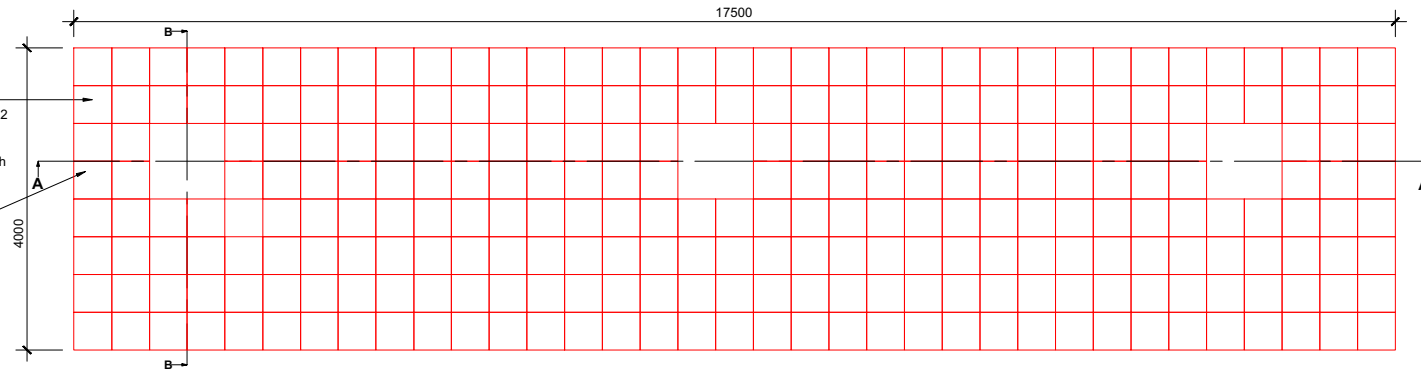

TOTAL ROOTING VOLUME  
FOR LINEAR PIT 42m<sup>3</sup>

NOTE:  
Incorporate RootStart Mycorrhiza - apply to tree pit at time of planting in accordance with manufacturers recommendations - allow 200g per tree.  
ULLSSP66 Ullswater vertical steel tree guard 1.8m high x 600mm diameter secured to grille  
AVON12A Avon DTS tree grille 1200 x 1200mm x 20mm RootStart irrigation inlet finished with pea gravel  
Galvanised tree grille support frame - set on concrete haunch  
RD1000-RS Raunch Space RootDirector - medium, modular root barrier system  
Back filled with BS3882 sandy loam - topsoil  
RootSpace structure - 1 upright deep x 35 uprights across x 8 uprights wide (1 x 2 x 2 module void below RootDirector) loaded with Arbor Soil Hydro Topsoil & RootStart Tree Fertiliser c/w Airflow plastic with side panels  
GRN20 plastic open reinforcing mesh, 20mm aperture laid below and around sides of GeoNet  
Additional twinwall GeoNet (GLTWGNA) to be installed where sub-base is installed below 3% CBR - Minimum 2%  
Drainage layer - minimum 200mm depth Must be washed 10-20mm angular aggregate with no fines laid as flat as possible

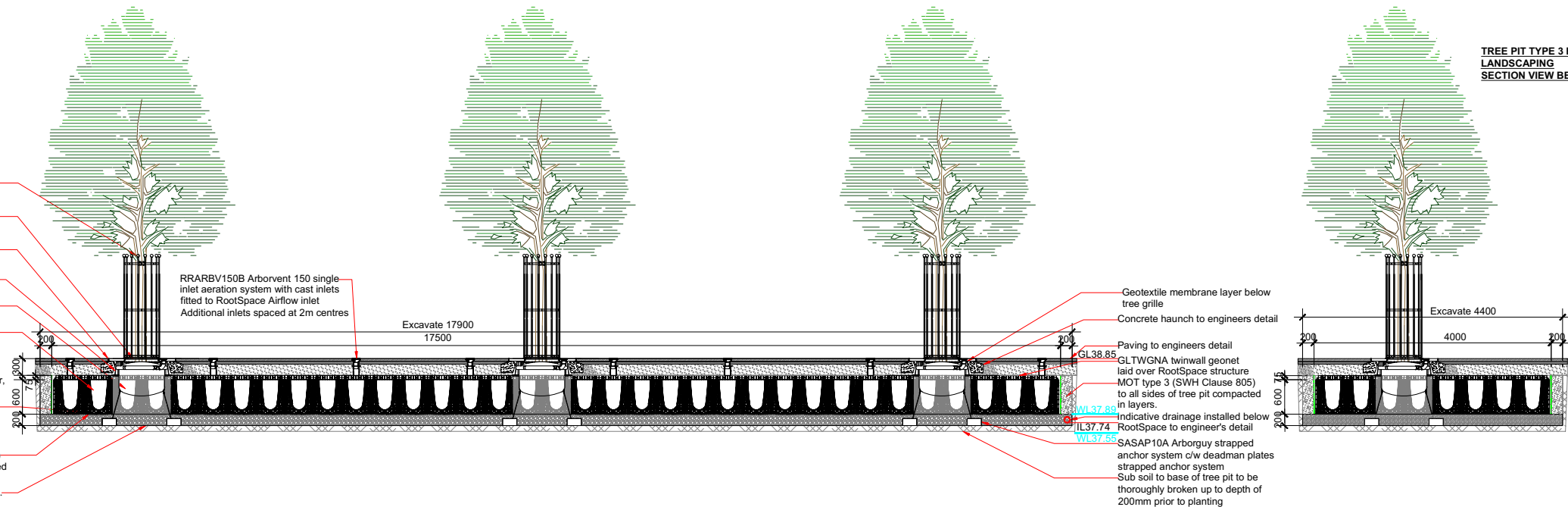

NOTE:  
SEE EML PEL 1099 01 FOR LANDSCAPING  
DETAILS

**TREE PIT DESIGNS TO BE CHECKED BY  
ENGINEERS FOR COMPLIANCE WITH  
WEIGHT LOADING REQUIREMENTS**

Rev:	Comments:	Date:
C1	Changed as per latest comments	16.12.21

© This drawing and the building works depicted are the copyright of East Midlands Landscaping Ltd and may not be reproduced or amended except by written permission. No liability will be accepted for amendments made by other persons.



Landscape Design, Management &amp; Consultancy

Title:	Tree Pit Details & Hedge Support Sheet 2 of 2
Client:	Pellikaan Construction Ltd
Project:	Melksham Community Campus Melksham House, 10 Thornbank, Melksham SN12 6ES

DWG No. EML PEL 1099 04

Status;	Construction	Date;	17.11.2020
Drawn;	JG	Revision;	C1
Checked;	JK	Scale;	1:50 @ A1

The Knoll, Leicester Road, Earl Shilton, Leicester, LE9 7TJ  
Tel: (01455) 850250  
email: [jon.king@eastmidlandslandscaping.co.uk](mailto:jon.king@eastmidlandslandscaping.co.uk)

**TREE PIT SOFT LANDSCAPING**

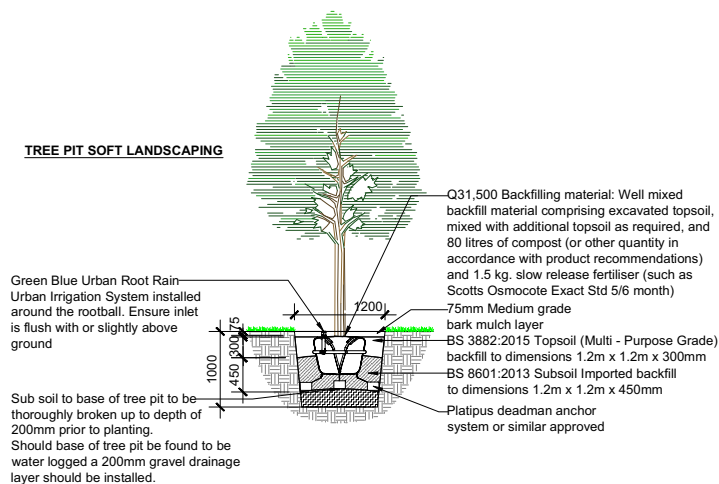

**HEDGEROW PROTECTION FENCING 1:20**

