

ABOVE GROUND UPVC WASTE DRAINAGE

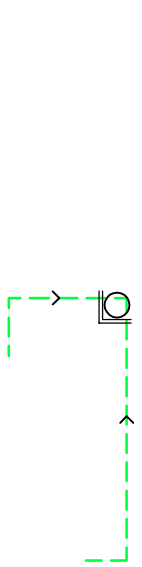

GENERAL NOTES:

TO BE READ IN CONJUNCTION WITH NBS R11 GENERALLY.

All bends & ends of run of soil & waste drainage are to be formed using access fittings to enable blockage clearance

pipework sizes -
w/c's - 100mm Ø (minimum gradient 1:30)
whibs - 32mm Ø where branch connection is max. 1.7m long & 40mm Ø where branch connection is max. 3m long (min gradient 1:45).
sinks - 38mm Ø (min gradient 1:45)

trap sizes -
whibs - 32mm Ø white plastic 75mm seal bottle trap.
sinks - 38mm Ø white plastic 75mm seal bottle trap.

If 2/10 or more of the above appliances occur on a common waste run then the minimum size of the common pipe is 50mm Ø unless a WC is part of the run then the minimum is to be 100mm Ø.

AIR ADAPTANCE VALVES:

Standard: To BS EN 12380 or Agreement certified.
Minimum air flow rate: To BS EN 12055-2.
Manufacturer: Healey Plumbing & Drainage
Product reference: ST04 durgio valve

boxings- in vertical s & v pipes -
provide and fix new contour pipe boxing full height vertically wherever pipework is visible

Pipes, fittings and accessories: MJUPVC to BS 5255, Kitemark certified.
Manufactured by: Healey Plumbing & Drainage Limited, Station road, Delamore, Northwich Cheshire CW9 2 JF Tel: 01606 889 809, Fax 01622 858 725 www.healey.co.uk

Size(s): DN 32, 40 & 50mm diameter
Colour: white
Accessories:couplers, bends, branches, access caps, reducers
Method of joining: Solvent welding
Method of fixing: standard pipe clips screwed to 100 x 75 x 25 mm softwood blocks glued to back of partition with contact adhesive in partition cavities
Refer to sanitaryware schedule for appliance details.

TO BE READ IN CONJUNCTION WITH NBS R10 GENERALLY.

ALUMINIUM RAIN WATER PIPEWORK:
Finish/Colour: Polyester powder coated, Colour: BS308B29 (RAL5014)
Van Dyke Brown

Boxing- in vertical rain water pipes - provide and fix new contour pipe boxing full height vertically wherever pipework is visible internally)

DRAINAGE FLOOR GULLIES:

ACO Building Drainage, circular stainless steel shower gullies with perforated gratings suitable for point drainage in wet rooms for sheet vinyl applications. All gully bodies supplied complete with integral removable foul air trap and Multi-fit 50mm/40mm waste pipe connectors.

INTERNAL RODDING EYES: as required
ACO Building Drainage, manufactured from austenitic 304 stainless steel. Suitable for drainage in changing rooms and showers.

REV	DESCRIPTION	DATE

Tender Issue

This design/document has been prepared by Bury MBC Architectural Services and is the property of Bury MBC. It is to be used for the purpose for which it was originally intended.

Department For
Resources & Regulation
Architectural Services
Bury
COUNCIL

3 Knowsley Place,
Duke Street,
Bury, Lancs. BL9 0EB
Tel: 0161 253 6989
Fax: 0161 253 6193
Web: www.bury.gov.uk

PROJECT TITLE:
ELMS BANK SPECIALIST ARTS COLLEGE
RIPON AVENUE, WHITEFIELD. M45 8PJ
HYDROTHERAPY POOL & CHANGING

DRAWING TITLE:

DRAINAGE ABOVE GROUND

DRAWN BY:	NB	DATE:	1/18	ISSUE NUMBER:
CHECKED BY:	RJV	DATE:	1/18	DATE OF ISSUE:
SCALE:	1:75 @ A1			

DRAWING NUMBER:

E 17301 A 15

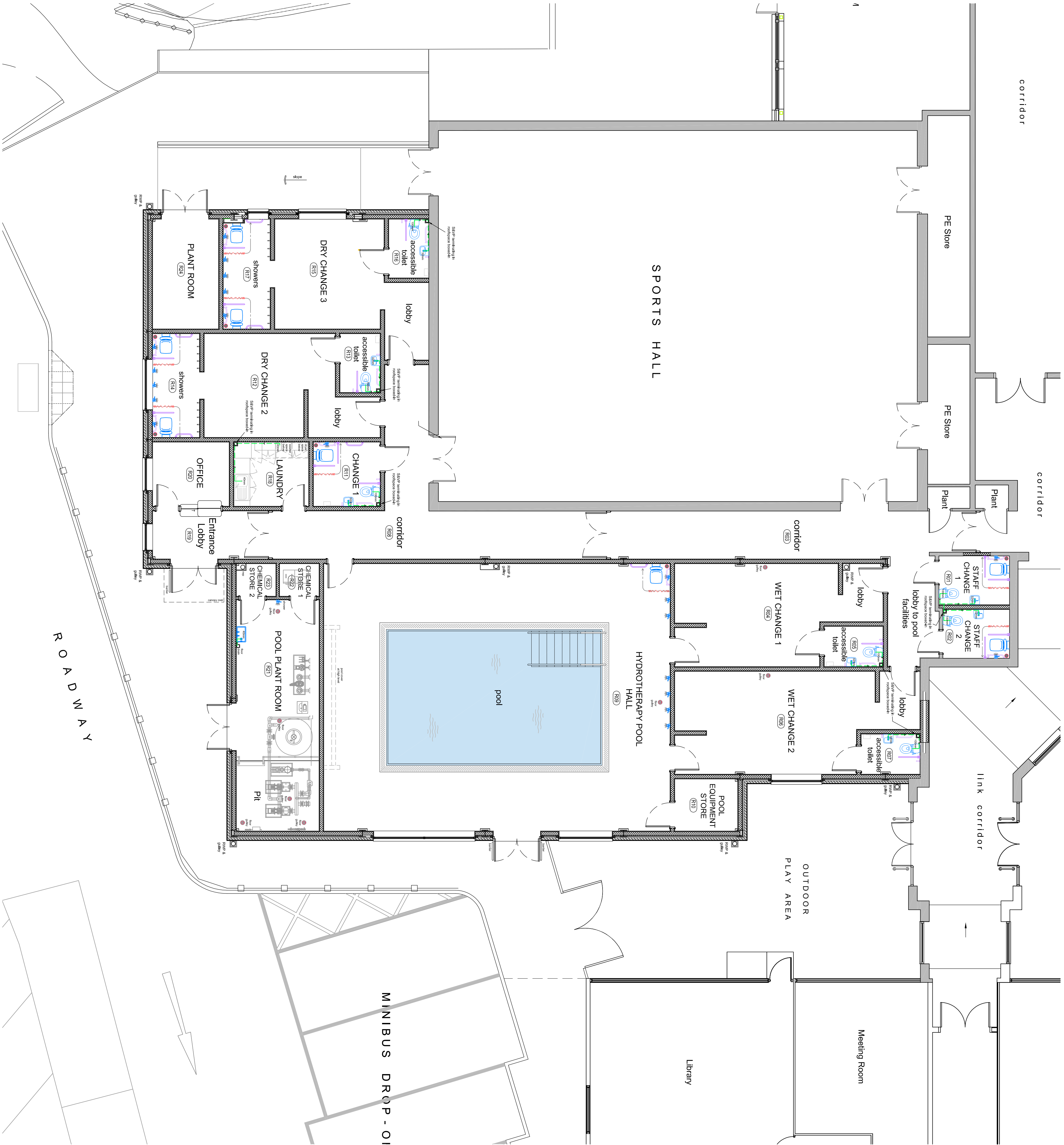

ABOVE GROUND DRAINAGE PLAN

Scale 1:75



GENERAL NOTES

THE CONTRACTOR IS ADVISED TO VISIT THE SITE PRIOR TO THE COMMENCEMENT OF WORKS TO IDENTIFY ANY OBSTRUCTIONS LIKELY TO AFFECT THE EXECUTION OF THE WORKS. NO CLAIMS ARISING FROM FAILURE TO DO SO WILL BE CONSIDERED.

THIS DRAWING IS TO BE READ IN CONJUNCTION WITH ALL OTHER DRAWINGS, SCHEDULES & SPECIFICATIONS RELATING TO THE PROJECT. ANY DISCREPANCIES NOTIFIED TO THE CONTRACT ADMINISTRATOR IMMEDIATELY.

THE CONTRACTOR IS TO CHECK ALL DIMENSIONS ON SITE PRIOR TO COMMENCING WORKS OR ORDERING ANY MATERIALS. DO NOT SCALE OFF DRAWINGS.

ALL WORKMANSHIP AND MATERIALS TO COMPLY WITH BUILDING REGULATIONS, BRITISH STANDARDS, CODES OF PRACTICE, INSTRUCTIONS, AGREEMENT CERTIFICATES ETC. ALL MATERIALS SHALL BE SUITABLE FOR PURPOSE.

THE CONTRACTOR IS TO MAKE GOOD ALL WORKS DISTURBED, AND SAFETY REQUIREMENTS WHERE APPROPRIATE.