

South Windermere Trail works: overview

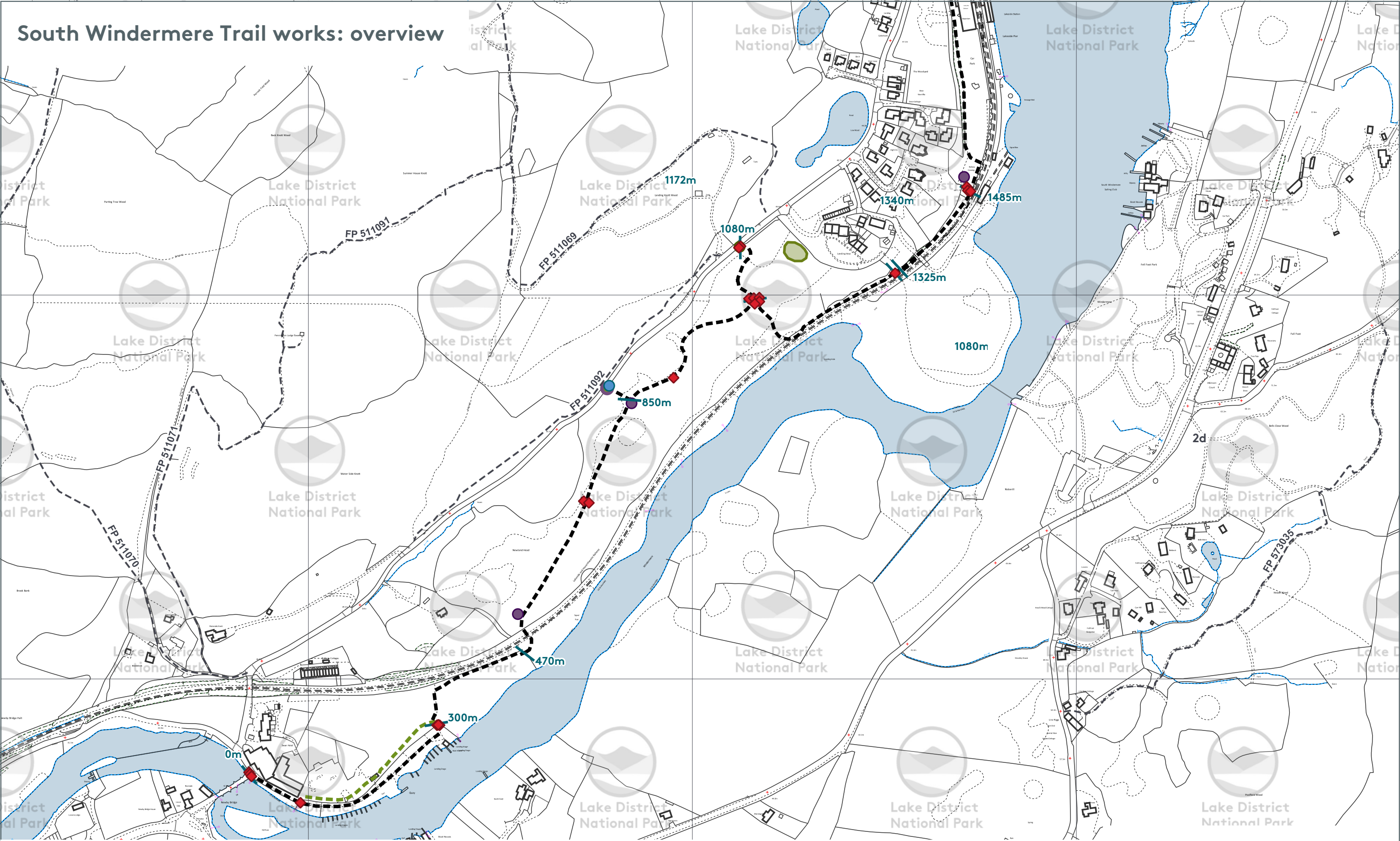

- South Windermere Trail route
- Access route
- Section break

- Access points
- Existing field gate
 - Existing field gate & access to compound
 - Trail access/egress onto main highway
 - Compound
 - Furniture and signage works

- Surfacing and linear works
- Bridge or boardwalk
 - Fencing
 - Path surfacing
 - Tarmac Drive - no surface treatment
 - Multiple work types



Lake District
National Park
Date: 27/08/2021

0 40 80 m

Centre of map: SD 3751 8674
© Crown copyright and
database right 2021
Ordnance Survey 100021698

You are not permitted to copy, sub-
licence, distribute or sell any of this
data to third parties in any form