

Contractor to check all dimensions and report any errors or omissions to the Design Team

Contractor is responsible for all setting out

Annotated dimensions to take preference over scaled dimensions

This drawing is the copyright of the City of Stoke on Trent Property + Asset Management Team and may not be loaned, copied or reproduced.

It is not to be used for any offer, quote, tender or construction purpose other than the intended without the written consent of the Director

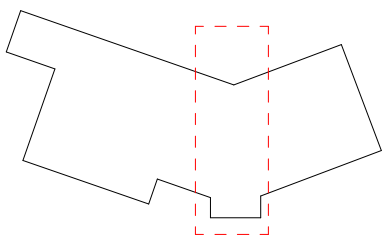

- LEGEND
- Signal Red RAL 3001
  - Signal Blue RAL 5005
  - Signal Yellow RAL 1003

Existing vinyl flooring to incorporate vinyl way finding graphics

CONTRACTOR TO ALLOW FOR COLOURS INDICATED BUT FINAL COLOURS TBC PRIOR TO ORDER BEING PLACED



REVISION	DATE	DESCRIPTION	ARCHITECT	PARTNER
A	29.06.20	Draft status - issued to Unilas for information		

CHECK ALL DIMENSIONS AND VERIFY ON SITE. REPORT ANY ERRORS OR OMISSIONS

DRAFT -  
INFORMATION



City of  
**Stoke-on-Trent**

JOB TITLE:  
**Meir C.E.C**

DRAWING TITLE:  
**GRAPHICS // PROPOSED**

SCALE: <b>As indicated</b>		DRAWING SHEET SIZE: <b>A1</b>	
JOB CODE: <b>Project Number</b>	DRAWING NUMBER: <b>A120</b>		REVISION: <b>A</b>

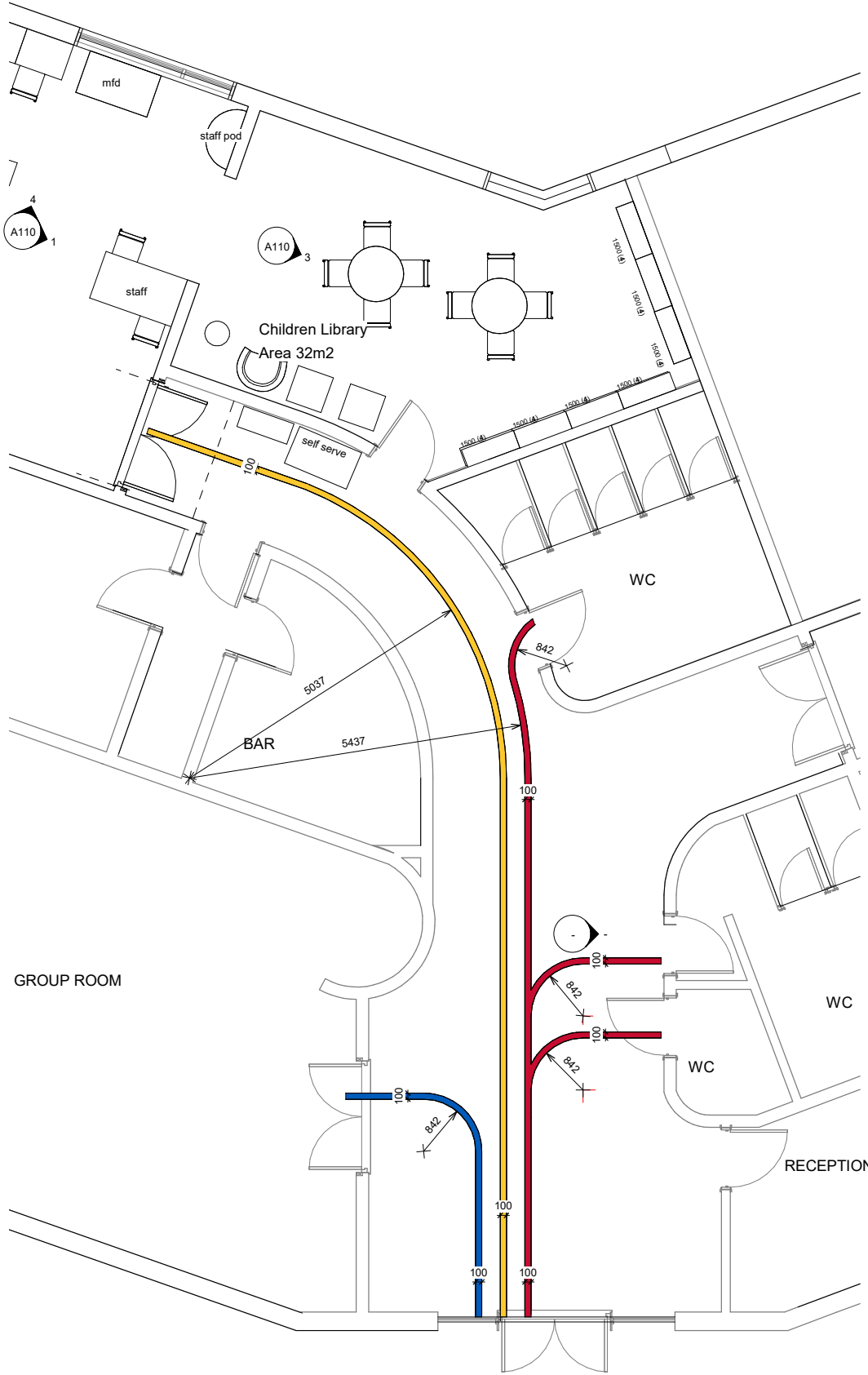

## Level 0 // Way Finding + Graphics

1 : 50

This line should measure 100mm along x and y axis when printed