



Premier event space in Gateshead



Festivals ■ Sports, runs & walks ■ Concerts ■ Cultural ■ Exhibitions ■ Conferences ■ Celebrations ■ Hospitality

Premier event spaces to hire providing some of the best views and facilities in Gateshead.

Welcome to Gateshead. Home to some of the most unique venues and breath-taking views in the North East. Our glorious Quayside showcases our most iconic structures including, the majestic Sage Gateshead, the stunning BALTIC Centre for Contemporary Art, and the magnificent bridges that span the River Tyne, linking Newcastle and Gateshead Quays.

Whether it's riverside tranquillity, historic magnificence or just a great functional space you need for your next event, you're sure to find something you'll love in Gateshead. Big or intimate, we've got you covered. You can even light up Gateshead Millennium Bridge in a colour of your choice to mark the occasion.

Venues

Baltic Square

Adjacent to BALTIC Centre for Contemporary Art and the iconic Gateshead Millennium Bridge, this premium riverside space is suitable for a variety of outdoor events. The only limit is your imagination.

Performance Square

Located next-door to the stunning Sage Gateshead Performance Square offers a large outdoor space ideal for a range of events. With panoramic views and a special 'cultural vibe', it could be just what you've been looking for.

St Mary's Heritage Centre

An exquisite Grade-1 listed former church, St. Mary's Heritage Centre offers a truly unique venue for your event. All set up for delivery of wedding receptions, conferences, compact festivals, cultural shows and exhibitions; this is a truly unique location to impress your guests.

Gateshead International Stadium

Only a very short distance away is Gateshead International Stadium, home to some of the region's most prestigious sporting, musical and entertainment events, both past and present. With substantial indoor and outdoor facilities, this could also be the place to host your next event.

All venues and locations benefit from excellent transport links and feature substantial car parking options.



Performance Square

Location: Next to Sage Gateshead

Facilities: Mains power available, suitable for event infrastructure

Size: Approx 2371.5m² with capacity for up to 2,000 people

Pricing: Full or half day available.
Special rates for photoshoots, runs and walks, hires are subject to an application fee and deposit.

Previously home to:

- Summer Tyne Americana Festival
- Folk on the Tyne
- Dine in the Sky

For more information about hiring the space:
0191 433 3120 or email culture@gateshead.gov.uk



Baltic Square

Location: Next to Gateshead Millennium Bridge, BALTIC and Sage Gateshead.

Facilities: Mains power available, suitable for event infrastructure

Size: Approx 2872m², with capacity for up to 2,500 people

Pricing: Full or half day available. Special rates for photoshoots, runs and walks, hires are subject to an application fee and deposit.

Previously home to:

- Q Festival
- Jesterval Comedy Festival
- Red Bull Neymar Jr's 5 Competition
- Great North City Games

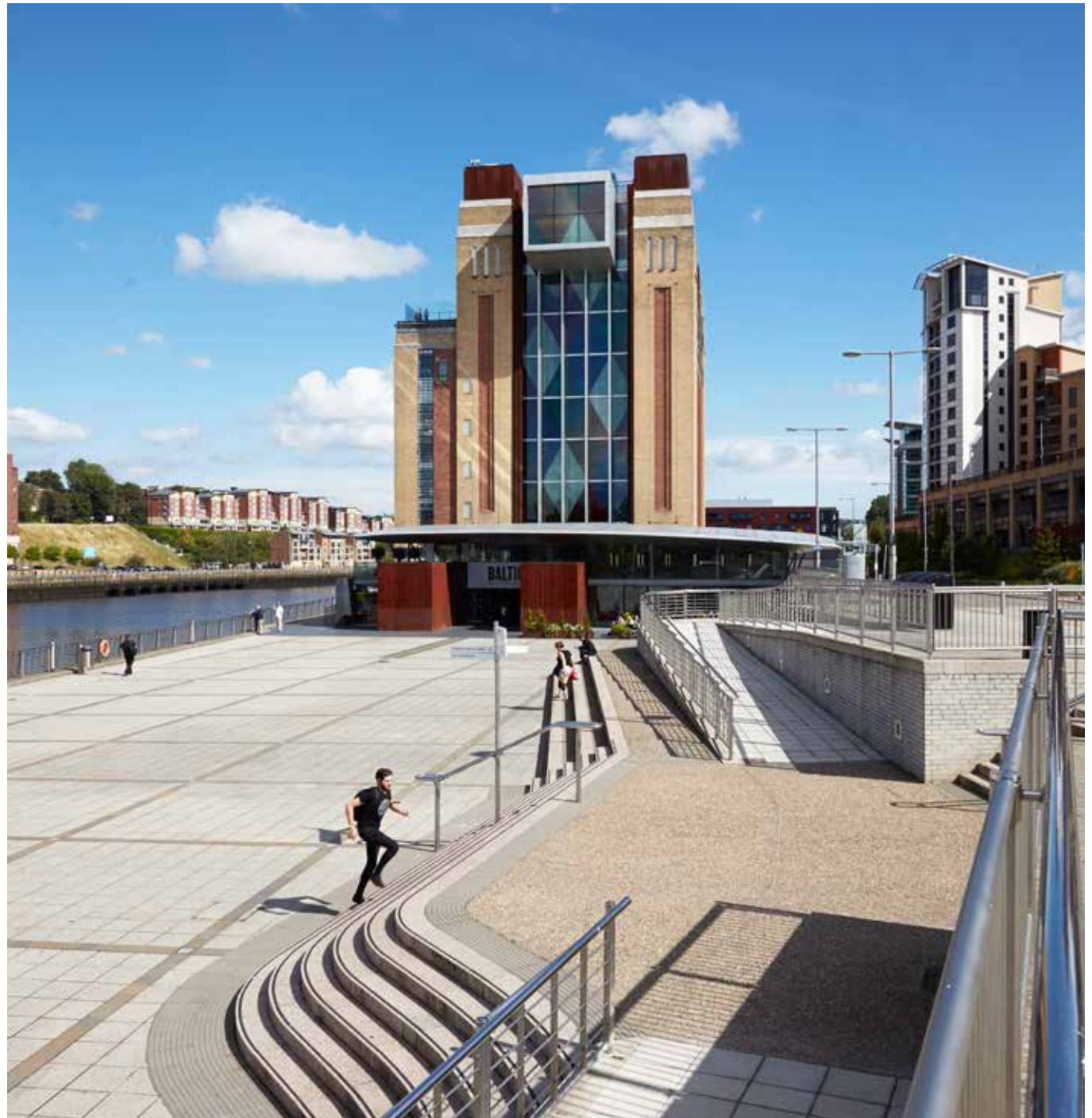



Location, location, location

Promotional space at Baltic Square

- Location:** Next to Gateshead Millennium Bridge, BALTIC and Sage Gateshead
- Facilities:** Mains power available, suitable for event infrastructure
- Size:** Approx 2872sqm
- Pricing:** Hourly, daily and weekend rates available

Your wedding at Baltic Square

Baltic Square is also available for hire for wedding receptions and photo opportunities, and to make it even more special, you can now light up the Gateshead Millennium Bridge in your special colours.

Talk to us about bringing your wedding party, transport and photographer to Baltic Square, and capture this moment in one of the most iconic and photographed locations in North East England.

- Light the bridge from dusk until 2am with a huge choice of colours
- Book access to Baltic Square for your vehicles, wedding party and photographer
- Share your special lighting on social media



**Light up
your big day**

with Gateshead
Millennium Bridge, see page 8



For more information about hiring the space: 0191 433 3120 or email culture@gateshead.gov.uk

St Mary's Heritage Centre

St. Mary's Heritage Centre is a Grade-1 listed former church that sits high above the River Tyne, with the iconic Tyne Bridge as a backdrop. This stunning piece of architecture offers beautiful period features and a truly unique and special venue for your next wedding reception, event, conference or meeting. With competitive prices, it also represents exceptional value for money.

Recently transformed with great links to public transport and local parking facilities, St Mary's Heritage Centre offers a grand space with plenty of character, away from the bustle of the city, right in the heart of our wonderful cultural Quays.

Wedding receptions

St. Mary's Heritage Centre offers you a truly beautiful and unique space for your wedding reception. With a late licence for music and entertainment, flexible options for catering, bars and venue styling, it's the perfect location for a day or evening of celebration.

Location: On Gateshead Quays next to the Sage Gateshead

Size: We can accommodate up to 110 guests for a banquet reception or 140 for a more informal layout.



Facilities: Evening receptions can include live music, DJ's and other entertainment up until 1am. There are flexible choices on catering, bar and venue styling.

Pricing: Private hire from just £1250

Conference, training and meeting space

Grand and light space ideal for events, conferences, meetings, socialising and away days. Take your colleagues and clients to a haven in the heart of the Quays. Perfect for your business needs. The Heritage Centre is divided into two spaces the main hall and the chancel, separated by a feature glass wall entrance.

Location: On Gateshead Quays adjacent to Sage Gateshead

Capacities (max): The Main Hall

Theatre style 140

Banquet style 110

Cabaret style 100

The Chancel

Conference/training layout 50

The Chancel can also be used as a breakout space or lunch area as part of a larger event.



Facilities

As standard we provide:

- PA, projection facilities, a small stage, TV screens, DVD and Blue Ray players
- LED theatre style lights which can change lighting levels and colour within the venue as required

Additional facilities:

- Additional technical support and equipment available to hire
- Refreshments, with a flexible choice of caterers for lunches or dinners, ensuring you can plan your event to suit your organisation.

Pricing: From hourly hires to full day and evening conferences speak to us about flexible pricing for your event.

For more information contact us on 0191 433 4699

email heritage@gateshead.gov.uk

www.gateshead.gov.uk/stmarysweddings

Make your mark after dark

Gateshead Quayside offers some of the most dramatic views of our beautiful riverside.

By day, the views of the River Tyne and our iconic bridges offer a moments tranquillity, but by night it's even more spectacular. The colourful tones that light the Gateshead Millennium Bridge can now be yours for the evening. Our sophisticated lighting system allows us to literally 'put you in lights'! So whether it's a corporate event, or you want to personally celebrate, we can add something truly unique to your special occasion.

Available for business, personal, weddings and events, light the bridge up in your unique colours

- The bridge is lit from dusk until 2am; let your colours shine over the cultural buzz of the Quayside
- Celebrate in style, and share your memory on Facebook, Twitter and Instagram
- To compliment your event, why not hire Baltic Square
- exclusive event space right next to Gateshead Millennium Bridge

Costs just £240+VAT (discounts available for charities and voluntary sector)

Available for business, personal, weddings and events, light the bridge up in your unique colours.

For enquiries and booking please call: 0191 433 3120 or email culture@gateshead.gov.uk



Light the bridge for your special celebration.

Gateshead International Stadium

One venue, so many possibilities

Located just a stone's throw away from the historic Gateshead Quayside, Gateshead International Stadium is renowned for hosting some of the region's largest local, national and international sporting, music and entertainment events. It could also be the ideal venue for your next event?

With versatile facilities and exceptional event delivery infrastructure, whatever you need, we've got you covered.

- Indoor and outdoor sports events
- Music concerts and entertainment events
- Business meetings and conferences
- Dining and corporate hospitality
- Trade shows and exhibitions
- Retail events
- Parties and celebrations
- Fairs and festivals
- Arena events
- Theatrical performances and shows
- Community and fundraising events

For more information contact:

0191 433 5700

[gatesheadinternationalstadium@
gateshead.gov.uk](mailto:gatesheadinternationalstadium@gateshead.gov.uk)

www.gateshead.gov.uk/gis

Neilson Road, Gateshead NE10 0EF



Transport links

Gateshead quayside is a central location with excellent transport links.

Walk: Access via Gateshead Millennium Bridge, and Southshore Road

Bus: Frequent connecting bus services

Road: Easily accessible with plentiful car parking

Train: Metro to Gateshead, Monument or rail to Central Station then yellow bus link to the Gateshead Quays

Cycle: On a major cycle route

For more travel information visit:
www.travelinenortheast.info
www.nexus.org.uk







To hire these spaces or to find out more please contact:

Baltic Square

Performance Square

Gateshead Millennium Bridge

0191 433 3120

culture@gateshead.gov.uk

St Mary's Heritage Centre

0191 433 4699

heritage@gateshead.gov.uk

www.gateshead.gov.uk/stmarysweddings

Gateshead International Stadium

0191 433 5700

gatesheadinternationalstadium@gateshead.gov.uk

www.gateshead.gov.uk/gis