

VISUAL SCALE 1:100

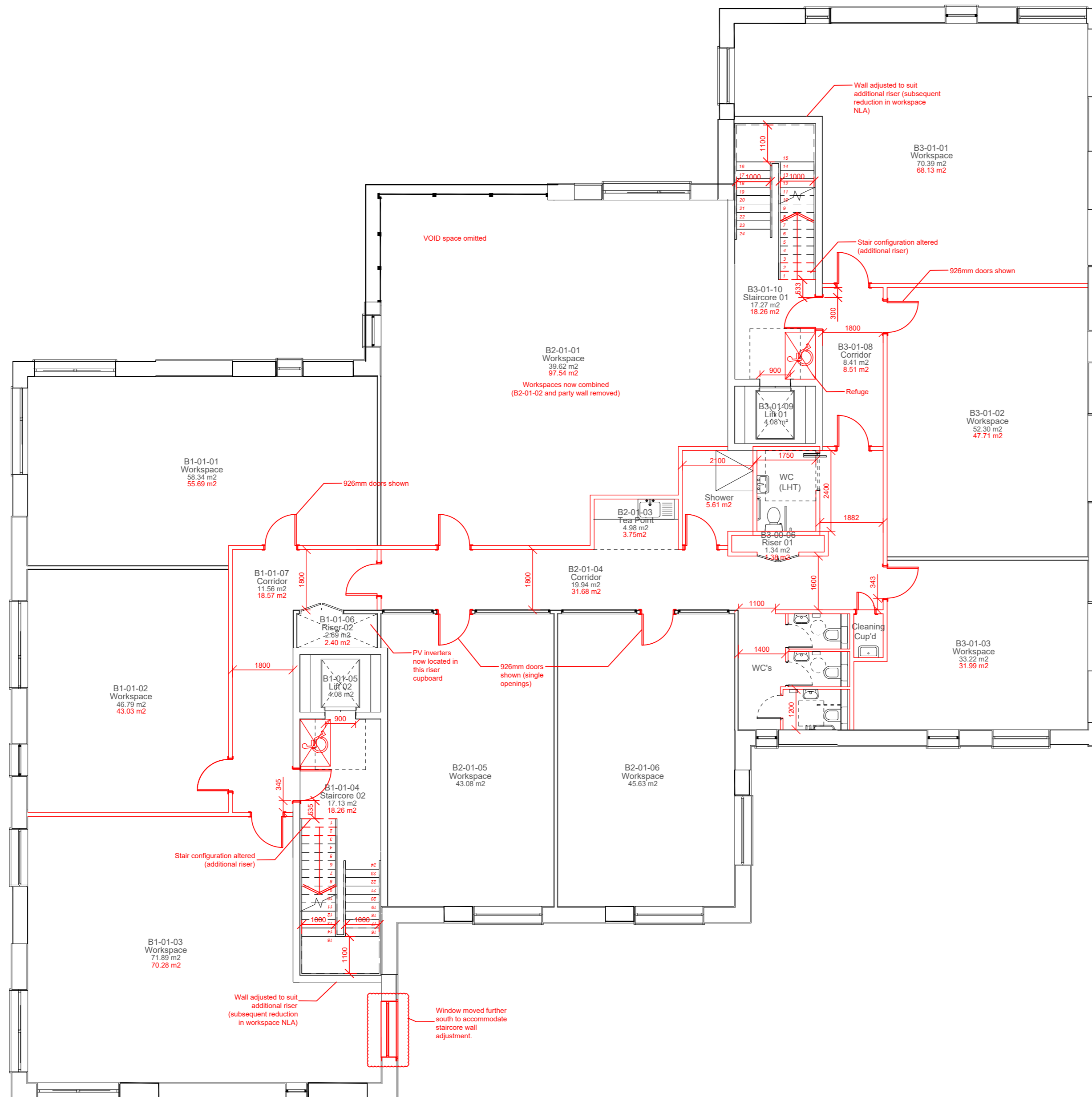

NOTE:
 REVISED AREA FIGURES ARE INDICATED IN **RED**
 BELOW THE ORIGINAL FIGURES, FOR EASE OF
 COMPARISON
 FINAL COLUMN LOCATIONS TBC

REV	DATE	COMMENTS	AUTHOR / CHECKED
F	09.12.20	Eastern window in workspace B1-01-03 moved further south to accommodate revised stair core dimensions	KS / GP
E	26.11.20	Lift door openings increased to 900mm	KS / GP
D	18.11.20	Double doors replaced with single leaf doors and PV inverter location highlighted	KS / GP
C	11.11.20	Shower added and WC/ Riser/ Teapoint/ cleaning cpd/ corridor door reconfigured. Void creating double height space removed and associated partition wall removed. NLA's adjusted.	KS / GP
B	05.11.20	Alterations to stair cores, NLA's, window to south of staircase 02 and ambulant WC	KS / GP
A	29.10.20	Minor internal alterations relating to WC's, removal of door from Workspace B2-01-02 into staircase. Update to floor area in room B2-01-03.	KS / GP

PROJECT TITLE
LISKEARD CATTLE MARKET WORK HUB

DETAIL
FIRST FLOOR INTERNAL REVISIONS

DRAWING NUMBER
 (PROJECT-ORIGINATOR-ZONE-LEVEL-TYPE-ROLE-NUMBER)
LCM -LHC - 00 - 00 - DR - AR - 02.01

STATUS	STATUS DESCRIPTION	
S3	FOR DISCUSSION	
REVISION	DATE	SCALE
F	22/10/20	1:100 @A2

CONTRACTORS MUST CHECK ALL DIMENSIONS ON SITE - ONLY FIGURED DIMENSIONS ARE TO BE WORKED FROM - DISCREPANCIES MUST BE REPORTED TO THE ARCHITECT BEFORE PROCEEDING © THIS DRAWING IS COPYRIGHT

LHC PROJECT NUMBER
19155

EXETER
 01392 444334
 PLYMOUTH
 01752 668368
 ST AUSTELL
 01726 213435
 lhc.net