

# *Development Survey Services Limited*

*Asbestos Surveys, consultancy and advice*

## **Asbestos Refurbishment/Demolition Survey for**

Oxford City Council

**at**

Museum of Oxford

Saint Aldate's

Oxford

Oxfordshire

OX11DZ



# Development Survey Services Ltd

## Names and Addresses

---

### Client Name:

**Oxford City Council**  
Housing and Property Services  
St Aldate's Chambers  
St Aldate's  
Oxford  
OX1 1DS

Contact: Steve Stansfield

Phone: 01865 252781 Fax:

### Instructing Party:

**Oxford City Council**  
Housing and Property Services  
St Aldate's Chambers  
St Aldate's  
Oxford  
OX1 1DS

Contact: Richard Davison

Phone: 01865 252781 Fax:

### Site Full Name:

**Museum of Oxford**  
Saint Aldate's  
Oxford  
Oxfordshire  
OX11DZ

Contact: Richard Davison

Phone: Fax:

### Report Author:

**Development Survey Services Ltd**  
67 Hill Croft  
Dunstable  
Bedfordshire  
LU6 1TT

Contact: Dominic Ayres  
Survey Director

Phone: 01582 517309 Fax:

Development Survey Services Ltd	Project Number:	J028078/DA/TG
	Survey Date:	06 September 2016
	Printed On:	12 September 2016
	Page:	Page 1 of 1

# TABLE OF CONTENTS

SECTION 1	Executive Summary
SECTION 2	Survey Drawings
SECTION 3	Survey Objectives
SECTION 4	Survey Techniques
SECTION 5	Survey Caveat
SECTION 6	Survey Notes
SECTION 7	Survey Summary
SECTION 8	Asbestos Register
SECTION 9	Material Assessment: Summary by Area
SECTION 10	Material Assessment: Summary by Floor
SECTION 11	Material Assessment: Summary by Asbestos Type
SECTION 12	Material Assessment (Photo)
SECTION 13	Bulk Certificate
SECTION 14	Pie Charts
SECTION 15	Priority Assessment: Summary by Area
SECTION 16	Priority Assessment: Summary by Floor
SECTION 17	Priority Assessment (Photo)
SECTION 18	Excluded Areas

# SECTION ONE

## EXECUTIVE SUMMARY

# Development Survey Services Ltd

## Executive Summary

---

### General Information:

Development Survey Services Ltd were instructed by Oxford City Council to carry out an Asbestos Refurbishment/Demolition Survey to inspect for the presence of asbestos containing materials (ACMs) at the following site:

Museum of Oxford

(See below for full list of areas inspected)

The building was constructed circa 1897.

The survey was carried out on 6th September 2016 by Dominic Ayres and Terence Glenister.

Ground floor and Basement areas of the Museum.

---

Client Name:	Oxford City Council	Project Number:	J028078/DA/TG
		Survey Date:	06 September 2016
Site Address:	Museum of Oxford. Saint Aldate's, Oxford, Oxfordshire, OX11DZ	Printed On:	12 September 2016
		Site Description:	Page 1 of 1

# SECTION TWO

## SURVEY DRAWINGS

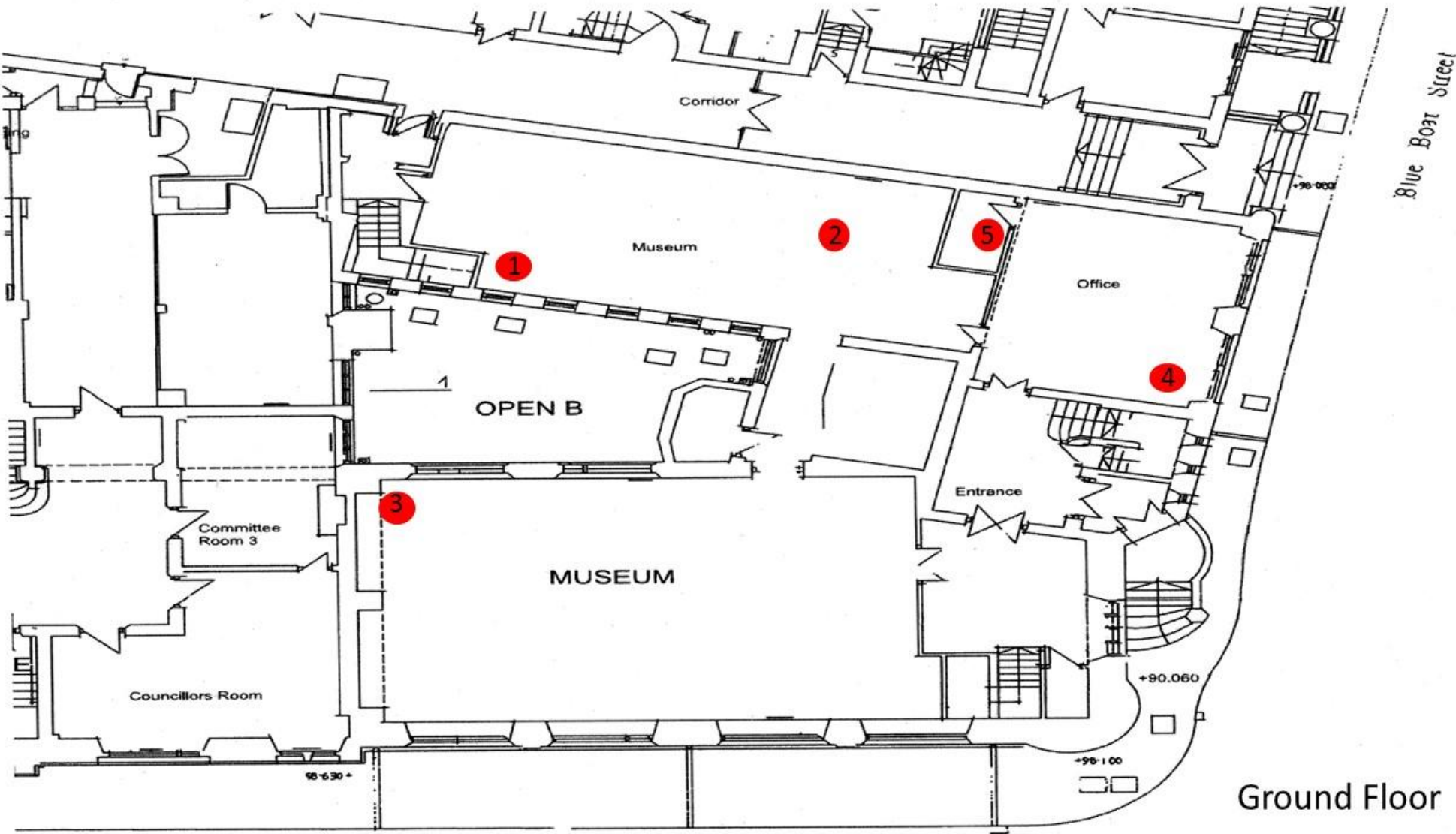

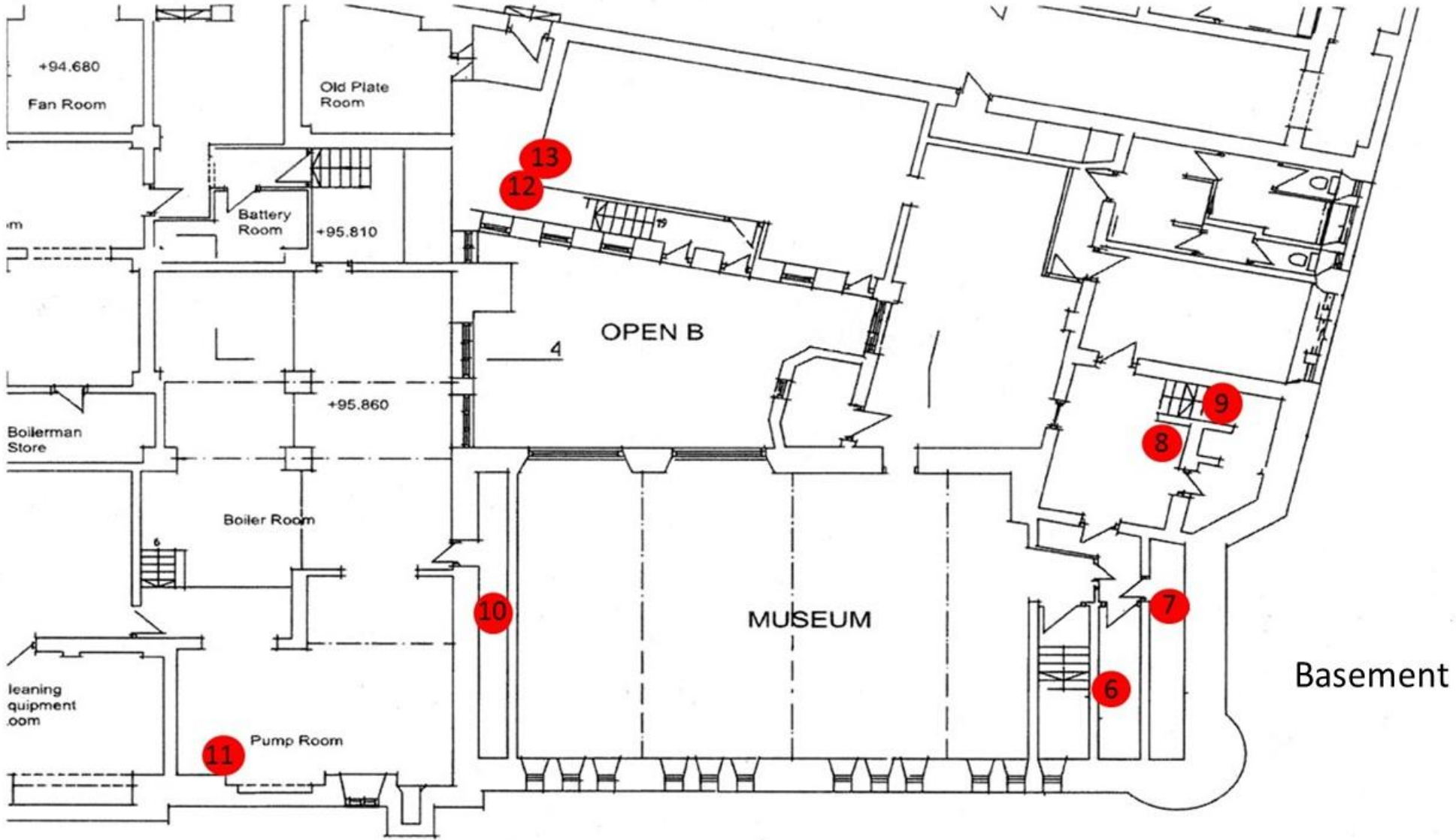



# SECTION THREE

## SURVEY OBJECTIVES

# Development Survey Services Ltd

## Survey Objectives

---

### 1 SURVEY OBJECTIVES

- 1.To locate and record the extent and product type of any presumed or known acms, as far as reasonably practicable.
- 2.To inspect and record information on accesibility to the said ACMs\*.
- 3.To determine and record the asbestos type by collecting representative samples of suspected materials for laboratory identification.
- 4.To make survey reports accessible for all relevant personnel.
- 5.The information is to be stored in a suitable form enabling amendments and revision in accordance with HSG264

Client Name:	Oxford City Council	Project Number:	J028078/DA/TG
		Survey Date:	06 September 2016
Site Address:	Museum of Oxford, Saint Aldate's, Oxford, Oxfordshire, OX11DZ	Printed On:	12 September 2016
		Survey Objectives:	Page 1 of 1

# SECTION FOUR

## SURVEY TECHNIQUES

# Development Survey Services Ltd

## Survey Techniques

---

- 1 Materials of a similar type were only occasionally sampled and it was assumed that other surfaces identical to where the sample was taken, was of a similar composition.
- 2 Photographs were taken at all of the sample locations (unless otherwise stated).
- 3 Samples were returned to the Main Laboratory for analysis.
- 4 all Asbestos Bulk Sample Analysis is conducted by using Polarised Light and Dispersion Staining Techniques. Dispersion Staining is used to describe the colour effects produced when a transparent colourless particle or fibre is immersed in a liquid having a refractive index near to that of the particle or fibre, and is viewed under a microscope using transmitted white light (based on HSE Publication MDHS 77).

Client Name:	Oxford City Council	Project Number:	J028078/DA/TG
		Survey Date:	06 September 2016
Site Address:	Museum of Oxford, Saint Aldate's, Oxford, Oxfordshire, OX11DZ	Printed On:	12 September 2016
		Survey Technique:	Page 1 of 1

# SECTION FIVE

## SURVEY CAVEAT

# Development Survey Services Ltd

## Survey Caveat

---

- 1 This report is based upon a destructive inspection of an unfamiliar site. All possible efforts were made to locate all ACM's contained within the structure of the building. It is known that asbestos materials are frequently concealed within the fabric of buildings or within sealed building voids so that it is not possible to regard the findings of any survey as being definitive. It must always remain a possibility that further asbestos containing materials may be found during refurbishment or demolition activities.

There are two types of survey that are in accordance with HSG264.

1. Management Survey.
2. Refurbishment/Demolition survey.

The survey used to determine the presence of asbestos at this location was a Refurbishment/Demolition Survey.

Client Name:	Oxford City Council	Project Number:	J028078/DA/TG
		Survey Date:	06 September 2016
Site Address:	Museum of Oxford, Saint Aldate's, Oxford, Oxfordshire, OX11DZ	Printed On:	12 September 2016
		Survey Caveat:	Page 1 of 1

# SECTION SIX

## SURVEY NOTES

# Development Survey Services Ltd

## Survey Notes

---

- 1      1 No air monitoring was carried out whilst the survey was undertaken and therefore care was taken not to cause disturbance of fibre or contamination of clean surfaces.
- 2 Any person undertaking work within the buildings should be told of the presence of asbestos. This briefing also applies to any other person associated with this site, including staff, sub-contractors and others.
- 3 All the recommendations described in this report are based upon assumptions made after consideration of the type of material, condition of material, its location, analysis result and type of use the area is thought to be subjected to. However, statutory authorities or others, could require amendments based on local knowledge, change in legislation, change in use or indeed, other conditions of criteria.
- 4 Equipment, machinery, ducting etc were not moved, opened up or examined for the purpose of this investigation except in the odd occasion where hatches were available.
- 5 Samples BS083308, BS083312, BS083318 and BS083319 all tested POSITIVE for Chrysotile asbestos fibres.  
All other samples tested NEGATIVE.

Client Name:	Oxford City Council	Project Number:	J028078/DA/TG
		Survey Date:	06 September 2016
Site Address:	Museum of Oxford, Saint Aldate's, Oxford, Oxfordshire, OX11DZ	Printed On:	12 September 2016
		Survey Objectives:	Page 1 of 1



# SECTION SEVEN

## SURVEY SUMMARY

# Development Survey Services Ltd

## Survey Summary

---

- 1 This report is in accordance with HSG264 guidelines, and is current at the date of this report and describes circumstances at the site on the date the investigation took place.
- No air monitoring was carried out whilst the survey was undertaken and therefore care was taken not to cause disturbance of fibre or contamination of clean surfaces.
- Any person undertaking work within the buildings needs information of the presence of asbestos. This briefing also applies to any other person associated with the site, including staff, subcontractors and others.
- The diagrams in the report are not to scale and are illustrative only to approximate locations.
- The descriptions used are for location identification purposes.
- The recommendations of this report are in accordance with HSG264 which is to gain access to all areas within the building including those that may be difficult to reach and to locate and describe as far as reasonably practicable all ACM's\* in the building.
- This may also involve destructive inspection, if previously agreed (ie Refurbishment/Demolition Survey).
- This survey does not assess the condition of the asbestos other than to note areas of damage or where additional asbestos debris may be expected to be present (ie Refurbishment/Demolition Survey). However, statutory authorities or others could require amendments based on local knowledge, change in legislation and change in use or indeed, other conditions of criteria.
- Equipment, including machinery, ducting etc that are inaccessible or unmovable in order to examine are not included in this survey, except in the odd occasion where hatches were available.
- If a material sampled contained asbestos, then the presumption is that other homogeneous materials used in the same way contain asbestos. Less homogeneous materials will require a greater number of samples.
- All samples are analysed at a suitable laboratory.
- Photographic evidence accompanies all presumed locations (unless otherwise stated). For positive identification of ACM's\* please refer to the individual photographic identifier pages. Development Survey Services Ltd. Are independent and specialise in asbestos surveys that are fully compliant with HSG264.

Client Name:	Oxford City Council	Project Number:	J028078/DA/TG
		Survey Date:	06 September 2016
Site Address:	Museum of Oxford, Saint Aldate's, Oxford, Oxfordshire, OX11DZ	Printed On:	12 September 2016
		Survey Summary:	Page 1 of 1

# SECTION EIGHT

## ASBESTOS REGISTER

# Asbestos Register

Site Name: Museum of Oxford

Project Number: J028078/DA/TG

Location	Product type and name		Extent	Accessibility	Condition	Surface treatment	Asbestos Type	Sample	Sample no	Material Risk Score	Priority Risk Score	Total Score
Museum, Ground floor, Raised platform	Plastics	Stair nosing	<=10 m² or <=10 m pipe run	Easy Accessibility	Low damage	Resins	Chrysotile	Identified	BS0833 08	3	5	8
Museum, Basement, Electrical cupboard	Asbestos cement	Cement Soffit	<=10 m² or <=10 m pipe run	Difficult Accessibility	Low damage	Asbestos cement sheets etc	Chrysotile	Identified	BS0833 12	4	2	6
Museum, Basement, Stairwell	Asbestos cement	Cement Soffit	<=10 m² or <=10 m pipe run	Difficult Accessibility	Low damage	Asbestos cement sheets etc	Chrysotile	Identified	BS0833 18	4	2	6
Museum, Basement, Stairwell	Asbestos cement	Cement Soffit	<=10 m² or <=10 m pipe run	Difficult Accessibility	Low damage	Asbestos cement sheets etc	Chrysotile	Identified	BS0833 19	4	2	6
Museum, Ground floor, Steamer room	Asbestos Insulating Board	Storage heater	Small items strings gaskets	Difficult Accessibility	No visible damage	Unsealed AIB	Chrysotile	Presumed	Presumed sample 1	5	5	10
Museum, Basement, Ladies room	Asbestos Insulating Board	Storage heater	Small items strings gaskets	Difficult Accessibility	No visible damage	Unsealed AIB	Chrysotile	Presumed	Presumed sample 2	5	3	8
Museum, Basement, Electrical cupboard	Asbestos Insulating Board	Flash guards to switchgear	Small items strings gaskets	Difficult Accessibility	No visible damage	Unsealed AIB	Chrysotile	Presumed	Presumed sample 3	5	2	7

MATERIAL SCORES ABOVE 10 HAVE HIGH POTENTIAL TO RELEASE FIBRES



# SECTION NINE

## MATERIAL ASSESSMENT: SUMMARY BY AREA

# Material Assessment: Summary by Area

Site Name: Museum of Oxford

Area: Museum

Project Number: J028078/DA/TG

Sample Date	Location Ref	Location ID	Drawing Reference	Floor	Room	Asbestos Type	Product Name	Material Risk Score	Material Risk Band	Priority Risk Score	Comments	Action	Survey Type
12/09/16	BS08331 3	1158		Basement	Crawl space	NADIS	Debris	0	NADIS	N/A		No Action Required	RDS
12/09/16	BS08331 6	1161		Basement	Crawl space	NADIS	Residue to pipe	0	NADIS	N/A		No Action Required	RDS
12/09/16	BS08331 2	1157		Basement	Electrical cupboard	Chrysotile	Cement Soffit	4	Very Low Risk	2		Removal	RDS
12/09/16	Presumed sample 3	1167		Basement	Electrical cupboard	Chrysotile	Flash guards to switchgear	5	Low Risk	2		To be included in management plan	RDS
12/09/16	Presumed sample 2	1166		Basement	Ladies room	Chrysotile	Storage heater	5	Low Risk	3		To be included in management plan	RDS
12/09/16	BS08331 7	1162		Basement	Pump room	NADIS	String to cables	0	NADIS	N/A		No Action Required	RDS
12/09/16	BS08331 4	1159		Basement	Staff kitchen	NADIS	Sink Pad	0	NADIS	N/A		No Action Required	RDS
12/09/16	BS08331 5	1160		Basement	Staircase	NADIS	Stair nosing	0	NADIS	N/A		No Action Required	RDS
12/09/16	BS08331 8	1163		Basement	Stairwell	Chrysotile	Cement Soffit	4	Very Low Risk	2		Removal	RDS
12/09/16	BS08331 9	1164		Basement	Stairwell	Chrysotile	Cement Soffit	4	Very Low Risk	2		Removal	RDS
12/09/16	BS08331 1	1156		Ground floor	Cupboard	NADIS	Vinyl Flooring	0	NADIS	N/A		No Action Required	RDS
12/09/16	BS08330 7	1151		Ground floor	Exhibit area	NADIS	Adhesive residue to floor	0	NADIS	N/A		No Action Required	RDS
12/09/16	BS08330 9	1154		Ground floor	Inside ducting	NADIS	Dust sample	0	NADIS	N/A		No Action Required	RDS
12/09/16	BS08331 0	1155		Ground floor	Ladies room	NADIS	Sink Pad	0	NADIS	N/A		No Action Required	RDS
12/09/16	BS08330 8	1153		Ground floor	Raised platform	Chrysotile	Stair nosing	3	Very Low Risk	5		No Action Required	RDS
12/09/16	Presumed sample 1	1165		Ground floor	Steamer room	Chrysotile	Storage heater	5	Low Risk	5		To be included in management plan	RDS



# SECTION TEN

## MATERIAL ASSESSMENT SCHEDULE BY FLOOR

# Material Assessment Schedule By Floor

Site Name: Museum of Oxford

Floor: Basement

Project Number: J028078/DA/TG

Sample Date	Location Ref	Location ID	Drawing Reference	Area	Room	Asbestos Type	Product Name	Material Risk Score	Material Risk Band	Priority Risk Score	Comments	Action	Survey Type
12/09/16	BS08331 2	1157		Museum	Electrical cupboard	Chrysotile	Cement Soffit	4	Very Low Risk	2		Removal	RDS
12/09/16	BS08331 3	1158		Museum	Crawl space	NADIS	Debris	0	NADIS	N/A		No Action Required	RDS
12/09/16	BS08331 4	1159		Museum	Staff kitchen	NADIS	Sink Pad	0	NADIS	N/A		No Action Required	RDS
12/09/16	BS08331 5	1160		Museum	Staircase	NADIS	Stair nosing	0	NADIS	N/A		No Action Required	RDS
12/09/16	BS08331 6	1161		Museum	Crawl space	NADIS	Residue to pipe	0	NADIS	N/A		No Action Required	RDS
12/09/16	BS08331 7	1162		Museum	Pump room	NADIS	String to cables	0	NADIS	N/A		No Action Required	RDS
12/09/16	BS08331 8	1163		Museum	Stairwell	Chrysotile	Cement Soffit	4	Very Low Risk	2		Removal	RDS
12/09/16	BS08331 9	1164		Museum	Stairwell	Chrysotile	Cement Soffit	4	Very Low Risk	2		Removal	RDS
12/09/16	Presumed sample 2	1166		Museum	Ladies room	Chrysotile	Storage heater	5	Low Risk	3		To be included in management plan	RDS
12/09/16	Presumed sample 3	1167		Museum	Electrical cupboard	Chrysotile	Flash guards to switchgear	5	Low Risk	2		To be included in management plan	RDS



# Material Assessment Schedule By Floor

Site Name: Museum of Oxford

**Floor:** Ground floor

Project Number: J028078/DA/TG

Sample Date	Location Ref	Location ID	Drawing Reference	Area	Room	Asbestos Type	Product Name	Material Risk Score	Material Risk Band	Priority Risk Score	Comments	Action	Survey Type
12/09/16	BS083307	1151		Museum	Exhibit area	NADIS	Adhesive residue to floor	0	NADIS	N/A		No Action Required	RDS
12/09/16	BS083308	1153		Museum	Raised platform	Chrysotile	Stair nosing	3	Very Low Risk	5		No Action Required	RDS
12/09/16	BS083309	1154		Museum	Inside ducting	NADIS	Dust sample	0	NADIS	N/A		No Action Required	RDS
12/09/16	BS083310	1155		Museum	Ladies room	NADIS	Sink Pad	0	NADIS	N/A		No Action Required	RDS
12/09/16	BS083311	1156		Museum	Cupboard	NADIS	Vinyl Flooring	0	NADIS	N/A		No Action Required	RDS
12/09/16	Presumed sample 1	1165		Museum	Steamer room	Chrysotile	Storage heater	5	Low Risk	5		To be included in management plan	RDS



# SECTION ELEVEN

## MATERIAL ASSESSMENT: SUMMARY BY ASBESTOS TYPE

# Material Assessment: Summary by Asbestos Type

Site Name: Museum of Oxford

## Asbestos Type: Chrysotile

Project Number: J028078/DA/TG

Sample Date	Location Ref	Location ID	Drawing Reference	Area	Floor	Room	Product Name	Material Risk Score	Material Risk Band	Priority Risk Score	Comments	Action	Survey Type
12/09/16	BS08331 2	1157		Museum	Basement	Electrical cupboard	Cement Soffit	4	Very Low Risk	2		Removal	RDS
12/09/16	Presumed sample 3	1167		Museum	Basement	Electrical cupboard	Flash guards to switchgear	5	Low Risk	2		To be included in management plan	RDS
12/09/16	Presumed sample 2	1166		Museum	Basement	Ladies room	Storage heater	5	Low Risk	3		To be included in management plan	RDS
12/09/16	BS08331 8	1163		Museum	Basement	Stairwell	Cement Soffit	4	Very Low Risk	2		Removal	RDS
12/09/16	BS08331 9	1164		Museum	Basement	Stairwell	Cement Soffit	4	Very Low Risk	2		Removal	RDS
12/09/16	BS08330 8	1153		Museum	Ground floor	Raised platform	Stair nosing	3	Very Low Risk	5		No Action Required	RDS
12/09/16	Presumed sample 1	1165		Museum	Ground floor	Steamer room	Storage heater	5	Low Risk	5		To be included in management plan	RDS

# Material Assessment: Summary by Asbestos Type

Site Name: Museum of Oxford

Asbestos Type: NADIS

Project Number: J028078/DA/TG

Sample Date	Location Ref	Location ID	Drawing Reference	Area	Floor	Room	Product Name	Material Risk Score	Material Risk Band	Priority Risk Score	Comments	Action	Survey Type
12/09/16	BS08331 3	1158		Museum	Basement	Crawl space	Debris	0	NADIS	N/A		No Action Required	RDS
12/09/16	BS08331 6	1161		Museum	Basement	Crawl space	Residue to pipe	0	NADIS	N/A		No Action Required	RDS
12/09/16	BS08331 7	1162		Museum	Basement	Pump room	String to cables	0	NADIS	N/A		No Action Required	RDS
12/09/16	BS08331 4	1159		Museum	Basement	Staff kitchen	Sink Pad	0	NADIS	N/A		No Action Required	RDS
12/09/16	BS08331 5	1160		Museum	Basement	Staircase	Stair nosing	0	NADIS	N/A		No Action Required	RDS
12/09/16	BS08331 1	1156		Museum	Ground floor	Cupboard	Vinyl Flooring	0	NADIS	N/A		No Action Required	RDS
12/09/16	BS08330 7	1151		Museum	Ground floor	Exhibit area	Adhesive residue to floor	0	NADIS	N/A		No Action Required	RDS
12/09/16	BS08330 9	1154		Museum	Ground floor	Inside ducting	Dust sample	0	NADIS	N/A		No Action Required	RDS
12/09/16	BS08331 0	1155		Museum	Ground floor	Ladies room	Sink Pad	0	NADIS	N/A		No Action Required	RDS

# SECTION TWELVE

## MATERIAL ASSESSMENT (PHOTO)

# Development Survey Services Ltd

## Material Assessment (Photo)

Sorted by: Location ID

Site Address: Museum of Oxford, Saint Aldate's, Oxford, Oxfordshire, OX11DZ

Client Name: Oxford City Council

Project Number: J028078/DA/TG

Location ID:	1151	Survey Type:	RDS
Location Ref:	BS083307	Product Type:	NADIS
Product:	Adhesive residue to floor	Damage:	NADIS
Area:	Museum	Treatment:	NADIS
Floor:	Ground floor	Asbestos Type:	NADIS
Room:	Exhibit area	Identification:	Identified
Surveyor Name:	Dominic Ayres and Terrence Glenister	Quantity:	
Drawing Ref:			
Asbestos ?	No		
Date:	12 September 2016		
Next Inspection:	Not Applicable		

Material Risk Score:	0
Material Risk Band:	NADIS
Priority Risk Score:	N/A

Action: No Action Required



Material Comments:

# Development Survey Services Ltd

## Material Assessment (Photo)

Sorted by: Location ID

Site Address: Museum of Oxford, Saint Aldate's, Oxford, Oxfordshire, OX11DZ

Client Name: Oxford City Council

Project Number: J028078/DA/TG

Location ID:	1153	Survey Type:	RDS
Location Ref:	BS083308	Product Type:	Plastics
Product:	Stair nosing	Damage:	Low damage
Area:	Museum	Treatment:	Resins
Floor:	Ground floor	Asbestos Type:	Chrysotile
Room:	Raised platform	Identification:	Identified
Surveyor Name:	Dominic Ayres and Terrence Glenister	Quantity:	
Drawing Ref:			
Asbestos ?	Yes		
Date:	12 September 2016		
Next Inspection:	12 September 2017		

Material Risk Score:	3
Material Risk Band:	Very Low Risk
Priority Risk Score:	5

Action: No Action Required



Material Comments:

# Development Survey Services Ltd

## Material Assessment (Photo)

Sorted by: Location ID

Site Address: Museum of Oxford, Saint Aldate's, Oxford, Oxfordshire, OX11DZ

Client Name: Oxford City Council

Project Number: J028078/DA/TG

Location ID:	1154	Survey Type:	RDS
Location Ref:	BS083309	Product Type:	NADIS
Product:	Dust sample	Damage:	NADIS
Area:	Museum	Treatment:	NADIS
Floor:	Ground floor	Asbestos Type:	NADIS
Room:	Inside ducting	Identification:	Identified
Surveyor Name:	Dominic Ayres and Terrence Glenister	Quantity:	
Drawing Ref:			
Asbestos ?	No		
Date:	12 September 2016		
Next Inspection:	Not Applicable		

Material Risk Score:	0
Material Risk Band:	NADIS
Priority Risk Score:	N/A

Action: No Action Required



Material Comments:



# Development Survey Services Ltd

## Material Assessment (Photo)

Sorted by: Location ID

Site Address: Museum of Oxford, Saint Aldate's, Oxford, Oxfordshire, OX11DZ

Client Name: Oxford City Council

Project Number: J028078/DA/TG

Location ID:	1155	Survey Type:	RDS
Location Ref:	BS083310	Product Type:	NADIS
Product:	Sink Pad	Damage:	NADIS
Area:	Museum	Treatment:	NADIS
Floor:	Ground floor	Asbestos Type:	NADIS
Room:	Ladies room	Identification:	Identified
Surveyor Name:	Dominic Ayres and Terrence Glenister	Quantity:	
Drawing Ref:			
Asbestos ?	No		
Date:	12 September 2016		
Next Inspection:	Not Applicable		

Material Risk Score:	0
Material Risk Band:	NADIS
Priority Risk Score:	N/A

Action: No Action Required



Material Comments:

# Development Survey Services Ltd

## Material Assessment (Photo)

Sorted by: Location ID

Site Address:

Museum of Oxford, Saint Aldate's, Oxford, Oxfordshire, OX11DZ

Client Name:

Oxford City Council

Project Number:

J028078/DA/TG

Location ID:	1156	Survey Type:	RDS
Location Ref:	BS083311	Product Type:	NADIS
Product:	Vinyl Flooring	Damage:	NADIS
Area:	Museum	Treatment:	NADIS
Floor:	Ground floor	Asbestos Type:	NADIS
Room:	Cupboard	Identification:	Identified
Surveyor Name:	Dominic Ayres and Terrence Glenister		Quantity:
Drawing Ref:			
Asbestos ?	No		
Date:	12 September 2016		
Next Inspection:	Not Applicable		

Material Risk Score:	0
Material Risk Band:	NADIS
Priority Risk Score:	N/A

Action:

No Action Required



Material  
Comments:

--

# Development Survey Services Ltd

## Material Assessment (Photo)

Sorted by: Location ID

Site Address:

Museum of Oxford, Saint Aldate's, Oxford, Oxfordshire, OX11DZ

Client Name:

Oxford City Council

Project Number:

J028078/DA/TG

Location ID:	1157	Survey Type:	RDS
Location Ref:	BS083312	Product Type:	Asbestos cement
Product:	Cement Soffit	Damage:	Low damage
Area:	Museum	Treatment:	Asbestos cement sheets etc
Floor:	Basement	Asbestos Type:	Chrysotile
Room:	Electrical cupboard	Identification:	Identified
Surveyor Name:	Dominic Ayres and Terrence Glenister	Quantity:	
Drawing Ref:			
Asbestos ?	Yes		
Date:	12 September 2016		
Next Inspection:	12 September 2017		

Material Risk Score:	4
Material Risk Band:	Very Low Risk
Priority Risk Score:	2

Action:

Removal



Material  
Comments:

--

# Development Survey Services Ltd

## Material Assessment (Photo)

Sorted by: Location ID

Site Address:

Museum of Oxford, Saint Aldate's, Oxford, Oxfordshire, OX11DZ

Client Name:

Oxford City Council

Project Number:

J028078/DA/TG

Location ID:	1158	Survey Type:	RDS
Location Ref:	BS083313	Product Type:	NADIS
Product:	Debris	Damage:	NADIS
Area:	Museum	Treatment:	NADIS
Floor:	Basement	Asbestos Type:	NADIS
Room:	Crawl space	Identification:	Identified
Surveyor Name:	Dominic Ayres and Terrence Glenister		Quantity:
Drawing Ref:			
Asbestos ?	No		
Date:	12 September 2016		
Next Inspection:	Not Applicable		

Material Risk Score:	0
Material Risk Band:	NADIS
Priority Risk Score:	N/A

Action:

No Action Required



Material  
Comments:

--

# Development Survey Services Ltd

## Material Assessment (Photo)

Sorted by: Location ID

Site Address:

Museum of Oxford, Saint Aldate's, Oxford, Oxfordshire, OX11DZ

Client Name:

Oxford City Council

Project Number:

J028078/DA/TG

Location ID:	1159	Survey Type:	RDS
Location Ref:	BS083314	Product Type:	NADIS
Product:	Sink Pad	Damage:	NADIS
Area:	Museum	Treatment:	NADIS
Floor:	Basement	Asbestos Type:	NADIS
Room:	Staff kitchen	Identification:	Identified
Surveyor Name:	Dominic Ayres and Terrence Glenister	Quantity:	
Drawing Ref:			
Asbestos ?	No		
Date:	12 September 2016		
Next Inspection:	Not Applicable		

Material Risk Score:	0
Material Risk Band:	NADIS
Priority Risk Score:	N/A

Action:

No Action Required



Material  
Comments:

--



# Development Survey Services Ltd

## Material Assessment (Photo)

Sorted by: Location ID

Site Address: Museum of Oxford, Saint Aldate's, Oxford, Oxfordshire, OX11DZ

Client Name: Oxford City Council

Project Number: J028078/DA/TG

Location ID:	1160	Survey Type:	RDS
Location Ref:	BS083315	Product Type:	NADIS
Product:	Stair nosing	Damage:	NADIS
Area:	Museum	Treatment:	NADIS
Floor:	Basement	Asbestos Type:	NADIS
Room:	Staircase	Identification:	Identified
Surveyor Name:	Dominic Ayres and Terrence Glenister	Quantity:	
Drawing Ref:			
Asbestos ?	No		
Date:	12 September 2016		
Next Inspection:	Not Applicable		

Material Risk Score:	0
Material Risk Band:	NADIS
Priority Risk Score:	N/A

Action: No Action Required



Material Comments:

# Development Survey Services Ltd

## Material Assessment (Photo)

Sorted by: Location ID

Site Address: Museum of Oxford, Saint Aldate's, Oxford, Oxfordshire, OX11DZ

Client Name: Oxford City Council

Project Number: J028078/DA/TG

Location ID:	1161	Survey Type:	RDS
Location Ref:	BS083316	Product Type:	NADIS
Product:	Residue to pipe	Damage:	NADIS
Area:	Museum	Treatment:	NADIS
Floor:	Basement	Asbestos Type:	NADIS
Room:	Crawl space	Identification:	Identified
Surveyor Name:	Dominic Ayres and Stephen Bowers	Quantity:	
Drawing Ref:			
Asbestos ?	No		
Date:	12 September 2016		
Next Inspection:	Not Applicable		

Material Risk Score:	0
Material Risk Band:	NADIS
Priority Risk Score:	N/A

Action: No Action Required



Material Comments:

# Development Survey Services Ltd

## Material Assessment (Photo)

Sorted by: Location ID

Site Address: Museum of Oxford, Saint Aldate's, Oxford, Oxfordshire, OX11DZ

Client Name: Oxford City Council

Project Number: J028078/DA/TG

Location ID:	1162	Survey Type:	RDS
Location Ref:	BS083317	Product Type:	NADIS
Product:	String to cables	Damage:	NADIS
Area:	Museum	Treatment:	NADIS
Floor:	Basement	Asbestos Type:	NADIS
Room:	Pump room	Identification:	Identified
Surveyor Name:	Dominic Ayres and Terrence Glenister	Quantity:	
Drawing Ref:			
Asbestos ?	No		
Date:	12 September 2016		
Next Inspection:	Not Applicable		

Material Risk Score:	0
Material Risk Band:	NADIS
Priority Risk Score:	N/A

Action: No Action Required



Material Comments:



# Development Survey Services Ltd

## Material Assessment (Photo)

Sorted by: Location ID

Site Address: Museum of Oxford, Saint Aldate's, Oxford, Oxfordshire, OX11DZ

Client Name: Oxford City Council

Project Number: J028078/DA/TG

Location ID:	1163	Survey Type:	RDS
Location Ref:	BS083318	Product Type:	Asbestos cement
Product:	Cement Soffit	Damage:	Low damage
Area:	Museum	Treatment:	Asbestos cement sheets etc
Floor:	Basement	Asbestos Type:	Chrysotile
Room:	Stairwell	Identification:	Identified
Surveyor Name:	Dominic Ayres and Terrence Glenister	Quantity:	
Drawing Ref:			
Asbestos ?	Yes		
Date:	12 September 2016		
Next Inspection:	12 September 2017		

Material Risk Score:	4
Material Risk Band:	Very Low Risk
Priority Risk Score:	2

Action: Removal



Material Comments:

# Development Survey Services Ltd

## Material Assessment (Photo)

Sorted by: Location ID

Site Address: Museum of Oxford, Saint Aldate's, Oxford, Oxfordshire, OX11DZ

Client Name: Oxford City Council

Project Number: J028078/DA/TG

Location ID:	1164	Survey Type:	RDS
Location Ref:	BS083319	Product Type:	Asbestos cement
Product:	Cement Soffit	Damage:	Low damage
Area:	Museum	Treatment:	Asbestos cement sheets etc
Floor:	Basement	Asbestos Type:	Chrysotile
Room:	Stairwell	Identification:	Identified
Surveyor Name:	Dominic Ayres and Terrence Glenister	Quantity:	
Drawing Ref:			
Asbestos ?	Yes		
Date:	12 September 2016		
Next Inspection:	12 September 2017		

Material Risk Score:	4
Material Risk Band:	Very Low Risk
Priority Risk Score:	2

Action: Removal



Material Comments:

# Development Survey Services Ltd

## Material Assessment (Photo)

Sorted by: Location ID

Site Address: Museum of Oxford, Saint Aldate's, Oxford, Oxfordshire, OX11DZ

Client Name: Oxford City Council

Project Number: J028078/DA/TG

Location ID:	1165	Survey Type:	RDS
Location Ref:	Presumed sample 1	Product Type:	Asbestos Insulating Board
Product:	Storage heater	Damage:	No visible damage
Area:	Museum	Treatment:	Unsealed AIB
Floor:	Ground floor	Asbestos Type:	Chrysotile
Room:	Steamer room	Identification:	Presumed
Surveyor Name:	Dominic Ayres and Terrence Glenister	Quantity:	
Drawing Ref:			
Asbestos ?	Yes		
Date:	12 September 2016		
Next Inspection:	14 March 2017		

Material Risk Score:	5
Material Risk Band:	Low Risk
Priority Risk Score:	5

Action: To be included in management plan



Material Comments:

# Development Survey Services Ltd

## Material Assessment (Photo)

Sorted by: Location ID

Site Address: Museum of Oxford, Saint Aldate's, Oxford, Oxfordshire, OX11DZ

Client Name: Oxford City Council

Project Number: J028078/DA/TG

Location ID:	1166	Survey Type:	RDS
Location Ref:	Presumed sample 2	Product Type:	Asbestos Insulating Board
Product:	Storage heater	Damage:	No visible damage
Area:	Museum	Treatment:	Unsealed AIB
Floor:	Basement	Asbestos Type:	Chrysotile
Room:	Ladies room	Identification:	Presumed
Surveyor Name:	Dominic Ayres and Terrence Glenister	Quantity:	
Drawing Ref:			
Asbestos ?	Yes		
Date:	12 September 2016		
Next Inspection:	14 March 2017		

Material Risk Score:	5
Material Risk Band:	Low Risk
Priority Risk Score:	3

Action: To be included in management plan



Material Comments:

# Development Survey Services Ltd

## Material Assessment (Photo)

Sorted by: Location ID

Site Address: Museum of Oxford, Saint Aldate's, Oxford, Oxfordshire, OX11DZ

Client Name: Oxford City Council

Project Number: J028078/DA/TG

Location ID:	1167	Survey Type:	RDS
Location Ref:	Presumed sample 3	Product Type:	Asbestos Insulating Board
Product:	Flash guards to switchgear	Damage:	No visible damage
Area:	Museum	Treatment:	Unsealed AIB
Floor:	Basement	Asbestos Type:	Chrysotile
Room:	Electrical cupboard	Identification:	Presumed
Surveyor Name:	Dominic Ayres and Terrence Glenister	Quantity:	
Drawing Ref:			
Asbestos ?	Yes		
Date:	12 September 2016		
Next Inspection:	14 March 2017		

Material Risk Score: 5

Material Risk Band: Low Risk

Priority Risk Score: 2

Action: To be included in management plan



Material Comments:

# SECTION THIRTEEN

## BULK CERTIFICATE



# Development Survey Services Ltd

## Bulk Certificate

Project Number:

J028078/DA/TG



### ASBESTOS BULK ANALYSIS TEST REPORT

**ams**  
management (GB) LLP

Unit 1, 9 Cannon Lane

Tonbridge, Kent TN9 1PP

Tel: 01732 368359

Fax: 01732 368361

Web: [www.ams-management.co.uk](http://www.ams-management.co.uk)

Registered in England and Wales 00311295

TEST REPORT NUMBER: J028078

Issue No: 01

Report Date: 09.09.16

Client: Development Surveys Services Limited  
31 Ashwell Park, Harpenden,  
Hertfordshire, AL5 5SG

Samples collected by:- Client

Date samples received by Lab:- 08.09.16

Laboratory Samples Analysed at:- Tonbridge

Total Number of Samples:- 13

Site/Location:- Museum Of Oxford, Saint Aldates,  
Oxford  
OX1 1DZ

Your Order:- Oxford City Council

Date Sampled:- N/A

Analysed By:- Alan Kane

Date Analysed:- 09.09.16

### TEST RESULTS

AMS Ref No.	Client Sample ID	Sample Location/Details	Sample/Material Type	Analysis Result	Content
BS083307	1	Ground Floor - Adhesive To Floor Of Exhibit Area	Bitumen Adhesive only	Asbestos Not Detected	Negative
BS083308	2	Ground Floor - Stair Nosing To Raised Platform	Plastic/Resin Products	Chrysotile	Positive
BS083309	3	Ground Floor - Debris To Inside Of Ducting	Dust/Debris	Asbestos Not Detected	Negative
BS083310	4	Ground Floor - Sink Pad To Sink In Ladies Room	Bitumen Products	Asbestos Not Detected	Negative
BS083311	5	Ground Floor - Vinyl Floor Covering Beneath Carpet In Cupboard	Vinyl Floor tiles	Asbestos Not Detected	Negative
BS083312	6	Basement - Cement Sheet Lining Soffit To Electrical Cupboard	Cement Products	Chrysotile	Positive
BS083313	7	Basement - Debris To Wall Bracket In Crawl Space	Dust/Debris	Asbestos Not Detected	Negative
BS083314	8	Basement - Sink Pad To Staff Kitchen Sink	Bitumen Products	Asbestos Not Detected	Negative
BS083315	9	Basement - Stair Nosing To Basement Staircase	Plastic/Resin Products	Asbestos Not Detected	Negative
BS083316	10	Basement - Residue To Pipe In Crawl Space	Residue	Asbestos Not Detected	Negative
BS083317	11	Basement - String To Pump Room Cables	Textiles & Gaskets	Asbestos Not Detected	Negative
BS083318	12	Basement - Cement Sheet Lining Staircase Soffit	Cement Products	Chrysotile	Positive

# Development Survey Services Ltd

## Bulk Certificate

Project Number:

J028078/DA/TG



### ASBESTOS BULK ANALYSIS TEST REPORT

**ams**  
management (GB) LLP

Unit 1, 9 Cannon Lane

Tonbridge, Kent TN9 1PP

Tel: 01732 368359

Fax: 01732 368361

Web: [www.ams-management.co.uk](http://www.ams-management.co.uk)

Registered in England and Wales OC311295

TEST REPORT NUMBER: J028078

Issue No: 01

Report Date: 09.09.16

Client:	Development Surveys Services Limited 31 Ashwell Park, Harpenden, Hertfordshire, AL5 5SG
Samples collected by:-	Client
Date samples received by Lab:-	08.09.16
Laboratory Samples Analysed at:-	Tonbridge
Total Number of Samples:-	13

Site/Location:-	Museum Of Oxford, Saint Aldates, Oxford OX1 1DZ
Your Order:-	Oxford City Council
Date Sampled:-	N/A
Analysed By:-	Alan Kane
Date Analysed:-	09.09.16

#### TEST RESULTS

AMS Ref No.	Client Sample ID	Sample Location/Details	Sample/Material Type	Analysis Result	Content
BS083319	13	Basement - Cement Sheet Lining Underneath Of Soffit	Cement Products	Chrysotile	Positive

.....END.....

**Key to fibre content:** Trace = Trace asbestos identified (1 to 2 fibres present); **Positive** = Asbestos identified (more than 2 fibres present).

**Method:** The analysis has been performed using the AMS 'In House' method of transmitted/polarised light microscopy and centre stop dispersion staining (Ref Appendix 2-Technical Procedure of Quality Manual), based on HSG248 and is covered by our UKAS Accreditation.

**The following are outside the scope of our UKAS Accreditation:**

1. Quantitative fibre content (Guidance on the percentages of asbestos used in various products is available in HSG264)
2. Sample Locations/Details supplied by the client. (AMS do not accept any responsibility for any discrepancy or inaccuracy arising from samples labelled or collected by clients or third parties)
3. Material Type/Description.
4. Any Interpretations or Opinions expressed in this Test Report

Samples are retained for not less than 6 months from date of analysis unless specifically requested otherwise.

This report relates only to the samples tested. This report may not be reproduced except in full, without prior approval of the laboratory

For and on behalf of AMS Management (GB) LLP

Alan Kane



# SECTION FOURTEEN

## PIE CHARTS

## Analysis by Asbestos Type

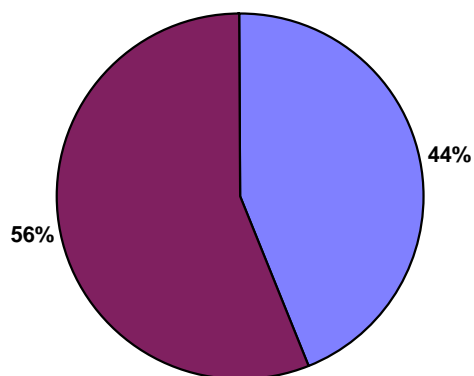

■ Chrysotile ■ NADIS

## Analysis by Risk Band

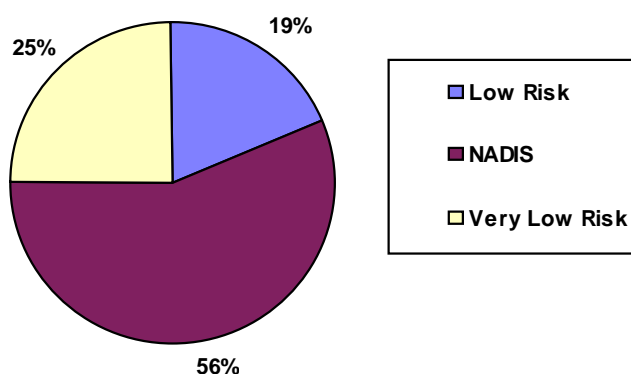

■ Low Risk  
■ NADIS  
■ Very Low Risk

## Analysis by Action

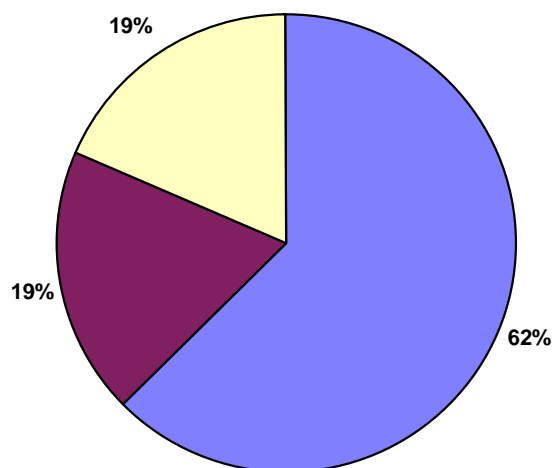

■ No Action Required  
■ Removal  
■ To be included in management plan

All charts show the latest Sample Inspection Data Only

Client Name:	Oxford City Council	Project Number:	J028078/DA/TG
		Survey Date:	06 September 2016
Site Address:	Museum of Oxford, Saint Aldate's, Oxford, Oxfordshire, OX11DZ	Printed On:	12 September 2016
		Survey Charts:	Page 1 of 1

# SECTION FIFTEEN

## PRIORITY ASSESSMENT: SUMMARY BY AREA

## Priority Assessment: Summary by Area

Site Name: Museum of Oxford

### Area: Museum

Project Number: J028078/DA/TG

Sample Date	Location Ref	Location ID	Drawing Reference	Floor	Room	Comments	Normal Occupant Activity	Likelihood Of Disturbance	Human Exposure Potential	Maintenance Activity	Risk Score
12/09/16	BS08331 2	1157		Basement	Electrical cupboard		0	1	1	0	2
12/09/16	Presumed sample 3	1167		Basement	Electrical cupboard		0	1	1	0	2
12/09/16	Presumed sample 2	1166		Basement	Ladies room		0	1	2	0	3
12/09/16	BS08331 8	1163		Basement	Stairwell		0	1	1	0	2
12/09/16	BS08331 9	1164		Basement	Stairwell		0	1	1	0	2
12/09/16	BS08330 8	1153		Ground floor	Raised platform		1	1	3	0	5
12/09/16	Presumed sample 1	1165		Ground floor	Steamer room		1	1	3	0	5

# SECTION SIXTEEN

## PRIORITY ASSESSMENT SCHEDULE

# Priority Assessment Schedule

Site Name: Museum of Oxford

Floor: Basement

Project Number: J028078/DA/TG

Sample Date	Location Ref	Location ID	Drawing Reference	Area	Room	Comments	Normal Occupant Activity	Likelihood Of Disturbance	Human Exposure Potential	Maintenance Activity	Risk Score
12/09/16	BS08331 2	1157		Museum	Electrical cupboard		0	1	1	0	2
12/09/16	BS08331 8	1163		Museum	Stairwell		0	1	1	0	2
12/09/16	BS08331 9	1164		Museum	Stairwell		0	1	1	0	2
12/09/16	Presumed sample 2	1166		Museum	Ladies room		0	1	2	0	3
12/09/16	Presumed sample 3	1167		Museum	Electrical cupboard		0	1	1	0	2

## Priority Assessment Schedule

Site Name: Museum of Oxford

**Floor:** Ground floor

Project Number: J028078/DA/TG

Sample Date	Location Ref	Location ID	Drawing Reference	Area	Room	Comments	Normal Occupant Activity	Likelihood Of Disturbance	Human Exposure Potential	Maintenance Activity	Risk Score
12/09/16	BS083308	1153		Museum	Raised platform		1	1	3	0	5
12/09/16	Presumed sample 1	1165		Museum	Steamer room		1	1	3	0	5

# SECTION SEVENTEEN

## PRIORITY ASSESSMENT RECORD



# Development Survey Services Ltd

## Priority Assessment Record

Sorted by: Location ID

Site Address:

Museum of Oxford, Saint Aldate's, Oxford,  
Oxfordshire, OX11DZ

Client Name:

Oxford City Council

Project Number:

J028078/DA/TG

Location ID:	1153
Location Ref:	BS083308
Product:	Stair nosing
Area:	Museum
Floor:	Ground floor
Room:	Raised platform
Surveyor Name:	Dominic Ayres and Terrence Glenister
Drawing Ref:	
Asbestos ?	Yes
Date:	12 September 2016



Priority  
Comments:

Priority Assessment Algorithm			
Assessment factor	Variable(s) selected	Score for each variable	Overall score
<b>Normal Occupant Activity:</b>			
Main type of activity in area:	Low disturbance	1	average
Secondary activities for area:	Low disturbance	1	1
<b>Likelihood Of Disturbance:</b>			
Location:	Rooms up to 100 m2	2	average 1
Accessibility:	Occasionally likely to be disturbed	1	
Extent/Amount:	<=10 m² or <=10 m pipe run	1	
<b>Human Exposure Potential:</b>			
Number of occupants:	>10	3	average 3
Frequency of use of area:	Daily	3	
Average time area is in use:	>6 hours	3	
<b>Maintenance Activity:</b>			
Type of maintenance activity:	Minor disturbance	0	average
Frequency of maintenance activity:	Unlikely to be disturbed	0	0

Total Priority Assessment Score:		5
Material Assessment Score (supplied by surveyor):	Very Low Risk	3
Total of Material and Priority Assessment Scores:		8

# Development Survey Services Ltd

## Priority Assessment Record

Sorted by: Location ID

Site Address:

Museum of Oxford, Saint Aldate's, Oxford,  
Oxfordshire, OX11DZ

Client Name:

Oxford City Council

Project Number:

J028078/DA/TG

Location ID:	1157
Location Ref:	BS083312
Product:	Cement Soffit
Area:	Museum
Floor:	Basement
Room:	Electrical cupboard
Surveyor Name:	Dominic Ayres and Terrence Glenister
Drawing Ref:	
Asbestos ?	Yes
Date:	12 September 2016



Priority  
Comments:

Priority Assessment Algorithm			
Assessment factor	Variable(s) selected	Score for each variable	Overall score
<b>Normal Occupant Activity:</b>			
Main type of activity in area:	Rare disturbance	0	average
Secondary activities for area:	Rare disturbance	0	0
<b>Likelihood Of Disturbance:</b>			
Location:	Rooms up to 100 m2	2	average 1
Accessibility:	Usually inaccessible or unlikely to be disturbed	0	
Extent/Amount:	<=10 m² or <=10 m pipe run	1	
<b>Human Exposure Potential:</b>			
Number of occupants:	1 to 3	1	average 1
Frequency of use of area:	Weekly	2	
Average time area is in use:	>1 to <3 hours	1	
<b>Maintenance Activity:</b>			
Type of maintenance activity:	Minor disturbance	0	average
Frequency of maintenance activity:	Unlikely to be disturbed	0	0

Total Priority Assessment Score:		2
Material Assessment Score (supplied by surveyor):	Very Low Risk	4
Total of Material and Priority Assessment Scores:		6

# Development Survey Services Ltd

## Priority Assessment Record

Sorted by: Location ID

Site Address:

Museum of Oxford, Saint Aldate's, Oxford,  
Oxfordshire, OX11DZ

Client Name:

Oxford City Council

Project Number:

J028078/DA/TG

Location ID:	1163
Location Ref:	BS083318
Product:	Cement Soffit
Area:	Museum
Floor:	Basement
Room:	Stairwell
Surveyor Name:	Dominic Ayres and Terrence Glenister
Drawing Ref:	
Asbestos ?	Yes
Date:	12 September 2016



Priority  
Comments:

Priority Assessment Algorithm			
Assessment factor	Variable(s) selected	Score for each variable	Overall score
<b>Normal Occupant Activity:</b>			
Main type of activity in area:	Rare disturbance	0	average
Secondary activities for area:	Rare disturbance	0	0
<b>Likelihood Of Disturbance:</b>			
Location:	Rooms up to 100 m2	2	average 1
Accessibility:	Usually inaccessible or unlikely to be disturbed	0	
Extent/Amount:	<=10 m <sup>2</sup> or <=10 m pipe run	1	
<b>Human Exposure Potential:</b>			
Number of occupants:	1 to 3	1	average 1
Frequency of use of area:	Weekly	2	
Average time area is in use:	<1 hour	0	
<b>Maintenance Activity:</b>			
Type of maintenance activity:	Minor disturbance	0	average
Frequency of maintenance activity:	Unlikely to be disturbed	0	0

Total Priority Assessment Score:	2
Material Assessment Score (supplied by surveyor):	Very Low Risk
Total of Material and Priority Assessment Scores:	6

# Development Survey Services Ltd

## Priority Assessment Record

Sorted by: Location ID

Site Address:

Museum of Oxford, Saint Aldate's, Oxford,  
Oxfordshire, OX11DZ

Client Name:

Oxford City Council

Project Number:

J028078/DA/TG

Location ID:	1164
Location Ref:	BS083319
Product:	Cement Soffit
Area:	Museum
Floor:	Basement
Room:	Stairwell
Surveyor Name:	Dominic Ayres and Terrence Glenister
Drawing Ref:	
Asbestos ?	Yes
Date:	12 September 2016



Priority  
Comments:

Priority Assessment Algorithm			
Assessment factor	Variable(s) selected	Score for each variable	Overall score
<b>Normal Occupant Activity:</b>			
Main type of activity in area:	Rare disturbance	0	average
Secondary activities for area:	Rare disturbance	0	0
<b>Likelihood Of Disturbance:</b>			
Location:	Rooms up to 100 m2	2	average 1
Accessibility:	Usually inaccessible or unlikely to be disturbed	0	
Extent/Amount:	<=10 m <sup>2</sup> or <=10 m pipe run	1	
<b>Human Exposure Potential:</b>			
Number of occupants:	1 to 3	1	average 1
Frequency of use of area:	Weekly	2	
Average time area is in use:	<1 hour	0	
<b>Maintenance Activity:</b>			
Type of maintenance activity:	Minor disturbance	0	average
Frequency of maintenance activity:	Unlikely to be disturbed	0	0

Total Priority Assessment Score:		2
Material Assessment Score (supplied by surveyor):	Very Low Risk	4
Total of Material and Priority Assessment Scores:		6

# Development Survey Services Ltd

## Priority Assessment Record

Sorted by: Location ID

Site Address:

Museum of Oxford, Saint Aldate's, Oxford,  
Oxfordshire, OX11DZ

Client Name:

Oxford City Council

Project Number:

J028078/DA/TG

Location ID:	1165
Location Ref:	Presumed sample 1
Product:	Storage heater
Area:	Museum
Floor:	Ground floor
Room:	Steamer room
Surveyor Name:	Dominic Ayres and Terrence Glenister
Drawing Ref:	
Asbestos ?	Yes
Date:	12 September 2016

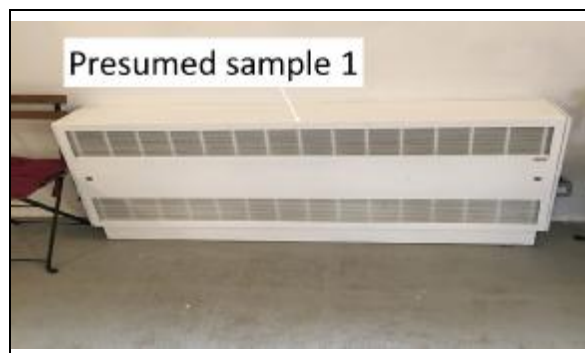

Priority  
Comments:

Priority Assessment Algorithm			
Assessment factor	Variable(s) selected	Score for each variable	Overall score
<b>Normal Occupant Activity:</b>			
Main type of activity in area:	Low disturbance	1	average
Secondary activities for area:	Low disturbance	1	1
<b>Likelihood Of Disturbance:</b>			
Location:	Rooms up to 100 m2	2	
Accessibility:	Usually inaccessible or unlikely to be disturbed	0	average
Extent/Amount:	Small items strings gaskets	0	1
<b>Human Exposure Potential:</b>			
Number of occupants:	>10	3	
Frequency of use of area:	Daily	3	average
Average time area is in use:	>6 hours	3	3
<b>Maintenance Activity:</b>			
Type of maintenance activity:	Minor disturbance	0	average
Frequency of maintenance activity:	Unlikely to be disturbed	0	0

Total Priority Assessment Score:		5
Material Assessment Score (supplied by surveyor):	Low Risk	5
Total of Material and Priority Assessment Scores:		10

# Development Survey Services Ltd

## Priority Assessment Record

Sorted by: Location ID

Site Address:

Museum of Oxford, Saint Aldate's, Oxford,  
Oxfordshire, OX11DZ

Client Name:

Oxford City Council

Project Number:

J028078/DA/TG

Location ID:	1166
Location Ref:	Presumed sample 2
Product:	Storage heater
Area:	Museum
Floor:	Basement
Room:	Ladies room
Surveyor Name:	Dominic Ayres and Terrence Glenister
Drawing Ref:	
Asbestos ?	Yes
Date:	12 September 2016

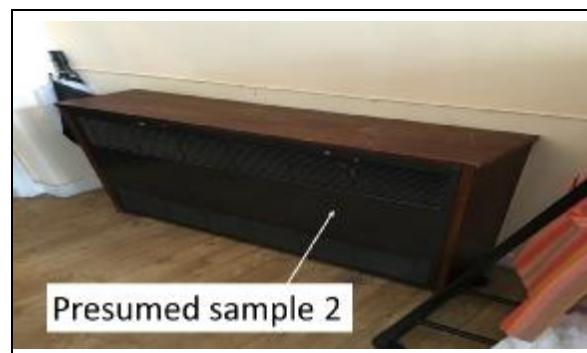

Priority  
Comments:

Priority Assessment Algorithm			
Assessment factor	Variable(s) selected	Score for each variable	Overall score
<b>Normal Occupant Activity:</b>			
Main type of activity in area:	Rare disturbance	0	average
Secondary activities for area:	Rare disturbance	0	0
<b>Likelihood Of Disturbance:</b>			
Location:	Rooms up to 100 m2	2	average 1
Accessibility:	Usually inaccessible or unlikely to be disturbed	0	
Extent/Amount:	Small items strings gaskets	0	
<b>Human Exposure Potential:</b>			
Number of occupants:	4 to 10	2	average 2
Frequency of use of area:	Daily	3	
Average time area is in use:	>3 to <6 hours	2	
<b>Maintenance Activity:</b>			
Type of maintenance activity:	Minor disturbance	0	average
Frequency of maintenance activity:	Unlikely to be disturbed	0	0

Total Priority Assessment Score:	3
Material Assessment Score (supplied by surveyor):	Low Risk 5
Total of Material and Priority Assessment Scores:	8

# Development Survey Services Ltd

## Priority Assessment Record

Sorted by: Location ID

Site Address:

Museum of Oxford, Saint Aldate's, Oxford,  
Oxfordshire, OX11DZ

Client Name:

Oxford City Council

Project Number:

J028078/DA/TG

Location ID:	1167
Location Ref:	Presumed sample 3
Product:	Flash guards to switchgear
Area:	Museum
Floor:	Basement
Room:	Electrical cupboard
Surveyor Name:	Dominic Ayres and Terrence Glenister
Drawing Ref:	
Asbestos ?	Yes
Date:	12 September 2016



Priority  
Comments:

Priority Assessment Algorithm			
Assessment factor	Variable(s) selected	Score for each variable	Overall score
<b>Normal Occupant Activity:</b>			
Main type of activity in area:	Rare disturbance	0	average
Secondary activities for area:	Rare disturbance	0	0
<b>Likelihood Of Disturbance:</b>			
Location:	Rooms up to 100 m2	2	average 1
Accessibility:	Usually inaccessible or unlikely to be disturbed	0	
Extent/Amount:	Small items strings gaskets	0	
<b>Human Exposure Potential:</b>			
Number of occupants:	1 to 3	1	average 1
Frequency of use of area:	Weekly	2	
Average time area is in use:	>1 to <3 hours	1	
<b>Maintenance Activity:</b>			
Type of maintenance activity:	Minor disturbance	0	average
Frequency of maintenance activity:	Unlikely to be disturbed	0	0

Total Priority Assessment Score:		2
Material Assessment Score (supplied by surveyor):	Low Risk	5
Total of Material and Priority Assessment Scores:		7

# SECTION EIGHTEEN

## EXCLUDED AREAS



# Development Survey Services Ltd

## Excluded Areas

---

The Following rooms / areas could not be accessed during the survey. Asbestos Containing Materials (ACMs) should be deemed as being present in these areas until proven otherwise.

---

- 1 This report relates to a survey carried out on the Ground floor and Basement areas relating to future refurbishment works at the Museum of Oxford as indicated to Development Survey Services in conversations with Oxford City Council. All other areas of the building not relating to these works are excluded from the scope of this survey.

Client Name:	Oxford City Council	Project Number:	J028078/DA/TG
		Survey Date:	06 September 2016
Site Address:	Museum of Oxford, Saint Aldate's, Oxford, Oxfordshire, OX11DZ	Printed On:	12 September 2016
		Excluded Areas:	Page 1 of 1