

01 First Floor Plan
1 : 50

Name	Area
Classroom 1	60.2 m²
Classroom 2	60.2 m²
Entrance Lobby	15.3 m²
W01	1.5 m²
Stairs	19.7 m²
Store 1a	2.3 m²
Store 1b	2.7 m²
Store 2a	4.9 m²
Store 2b	2.7 m²
WC 1	2.2 m²
WC 2	2.2 m²
WC Acc.	3.4 m²

Summary - Modules GF		
Qty.	Bay Width	Bay Length
0_GROUND FLOOR		
1	4000	13400
1	4000	6400
1	3600	12100
1	3600	7700
1	2100	12100
1	2100	7700
6		

Summary - Windows	
Qty.	Description
9	(120) 1135x1800mm Sgl-S (TOV/FXD) W02
10	(120) 1135x2700mm Sgl-S (TOV/FXD) W01
8	900x300 Louvre
27	

Summary - Doors	
Qty.	Description
Exterior	
1	(120) 1360x2400mm Feature Entrance ED03
2	(120) 1360x2700mm Feature Entrance ED02
Exterior: 3	
Interior: 3	
5	(70) 805x2095mm (F26) WC
1	(70) 1005x2095mm (F26) WC Acc.
2	(70) FD30s 805x2095mm (F26) Store
8	(70) FD30s 1005x2095mm (F26) Store
2	(70) FD30s 1505x2095mm (F26) Calculation
4	(70) FD30s 1505x2095mm (F26) Classroom
Interior: 22	

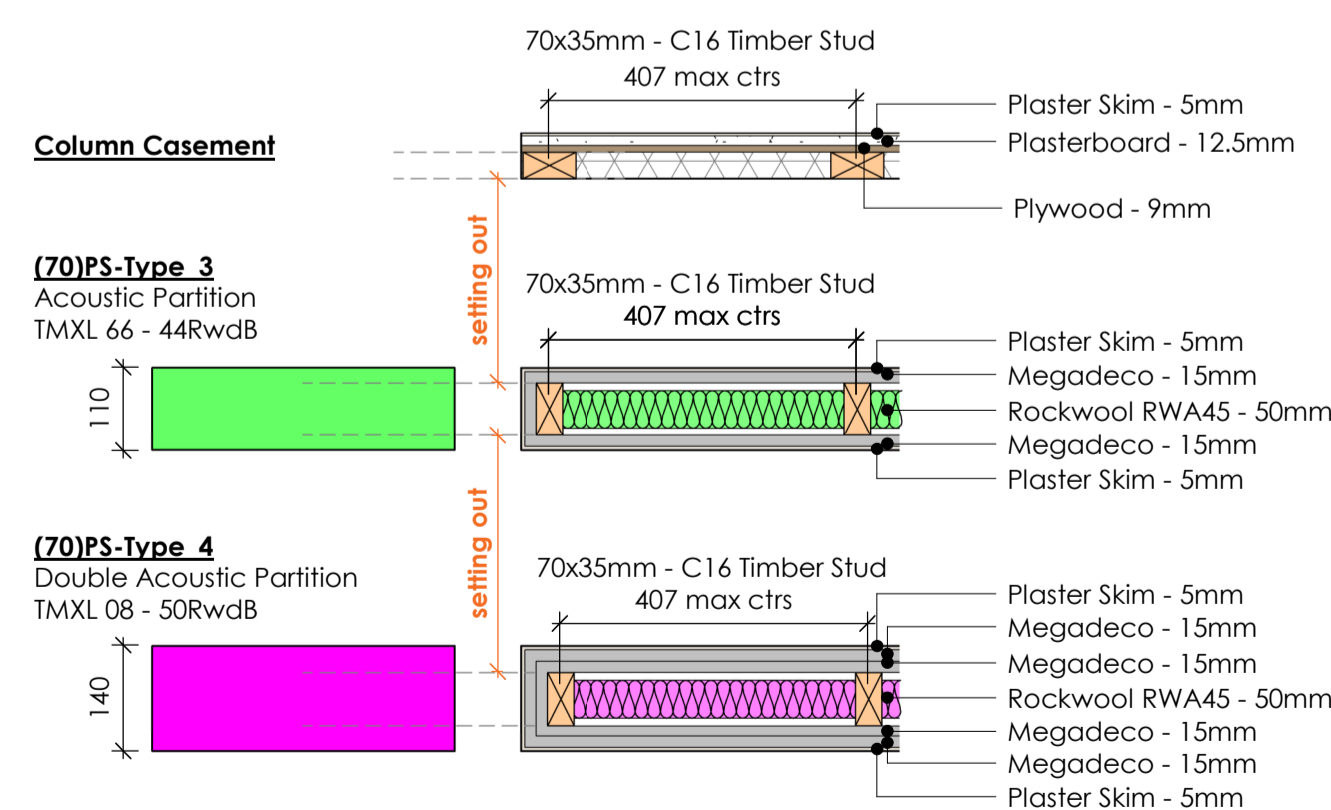

All wall setting out dimensions are to timber frame NOT FINISH FACE of wall.
External wall setting out dimensions are to outer face of column.

All wall setting out dimensions are to timber frame NOT FINISH FACE of wall.

External Wall Types - Plaster Skim
1 : 10

Internal Wall Types - Plaster Skim
1 : 10

DRAWING APPROVAL
Signed: _____
Date: _____

rev	description	by	date
08	Revised to suit comments	KJ	20/03/20
07	Revised to suit GDM comments	KJ	28/02/20
06	Revised to suit contractor and Architects comments	KJ	14/02/20
05	Revised to suit client comments	KJ	30/01/20
04	Revisions Post Issue 03M	RC	15/01/19
03	Updated in line with new Architects drawing	RC	03/12/19
02	Star core & ancillary spaces redesigned to suit revised GDM layout 9/12/19	CJ	26/09/19
01	First Issue	KJ	



Tel: 01964 626761
enquiries@integrabuildings.co.uk
www.integrabuildings.co.uk

client:
Kier
project:
Water Meadows Primary School

First Floor GA Plan

date: 10/09/19
drawn by: IBL
checked: KJ
scale: @ A1
19.20604
status: As indicated
drawing ref: 00-0101
rev: P08

