

Do not scale for construction purposes. If in doubt - ASK. The contractor is to check and verify all dimensions on site prior to construction.  
This drawing is not to be reproduced without written permission.

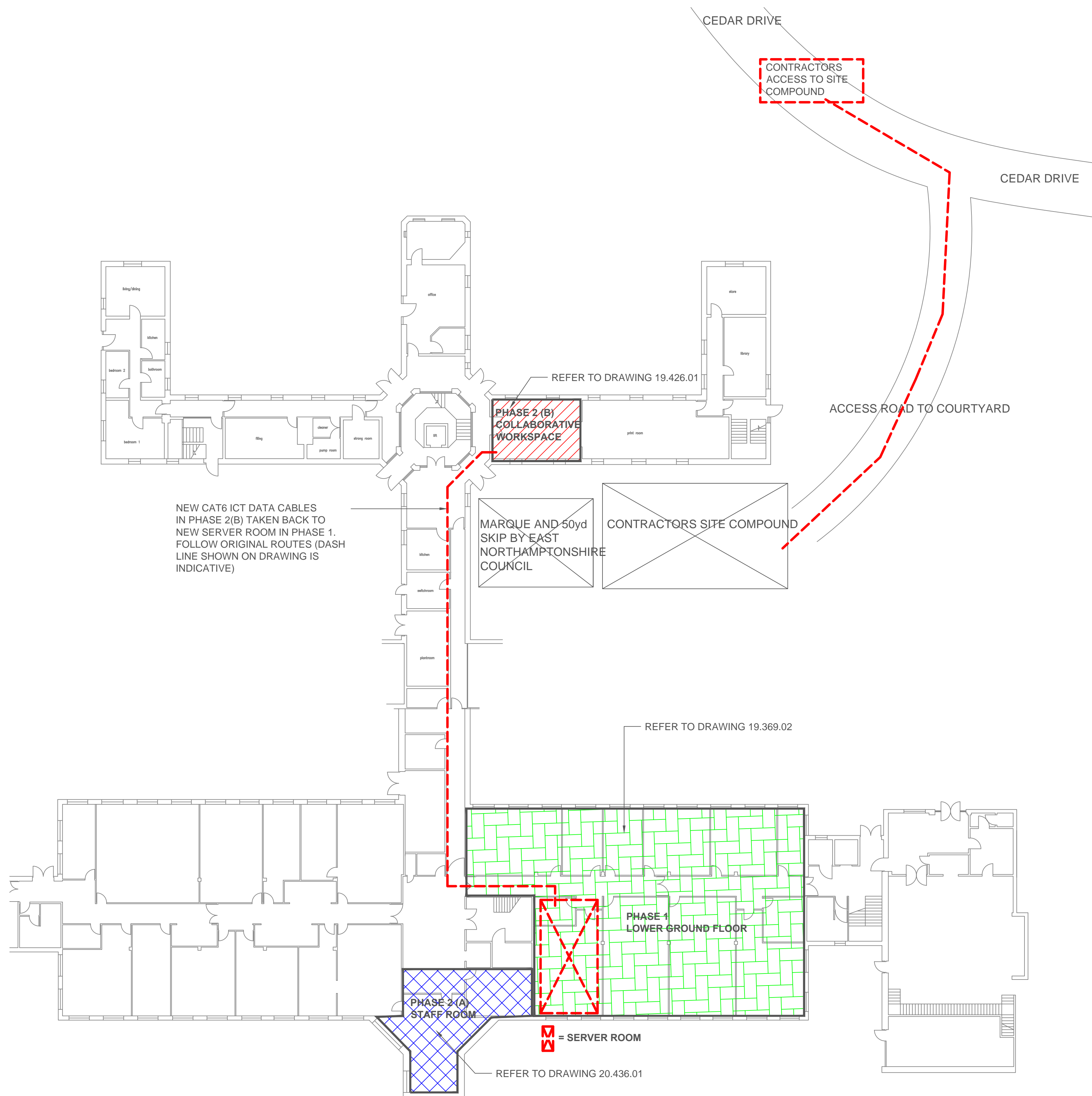

### 1. EXISTING FLOOR PLAN OF LOWER GROUND FLOOR (1:200)

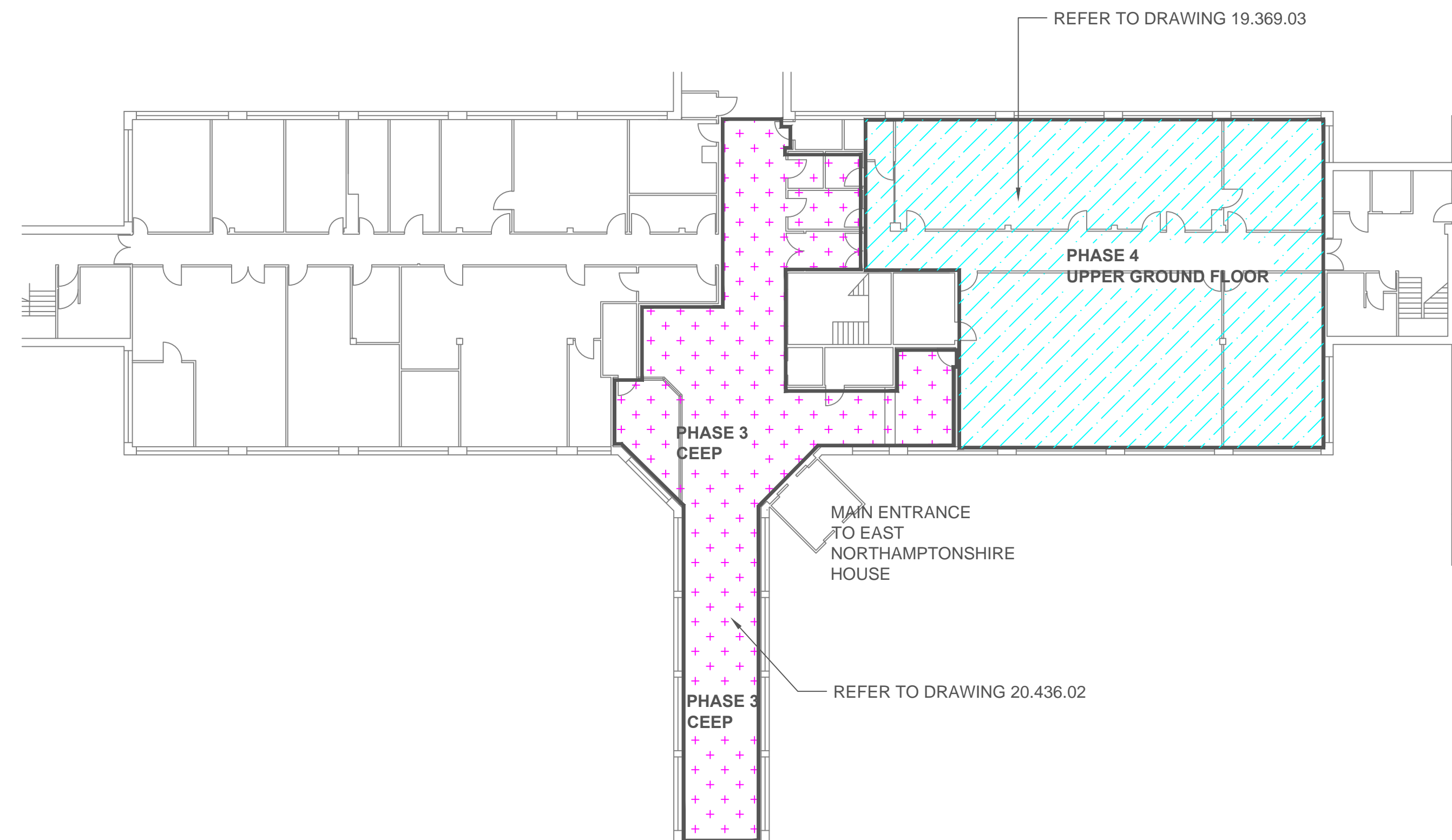

## 2. EXISTING FLOOR PLAN OF UPPER GROUND FLOOR (1:200)

A	3.2.20	Add indicative CAT6 cable route and phases
Revision	Date	Description

**BMO Surveying**  
Chartered Building Surveyors

Unit 8E Mobbs Miller House  
Christchurch Road  
Northampton  
NN1 5LL

Client: EAST NORTHAMPTONSHIRE COUNCIL  
CEDAR DRIVE, THRAPSTON  
NORTHAMPTONSHIRE

Project:  
OFFICE TRANSFORMATION PROJECT -  
PHASE 2 AT EAST NORTHAMPTONSHIRE  
HOUSE, CEDAR DRIVE, THRAPSTON  
NORTHAMPTONSHIRE

Drawing:

EXISTING FLOOR PLAN SHOWING  
PROPOSED PHASES AND LOCATION OF  
WORKS  
SITE CONSTRAINTS

Drawing number: 19.369.01		Rev: A	Date: JAN 2020
Scale: 1:100@A1	Drawn by: BOM	Checked by:	Sheet Size: A1
Status: TENDER			