

TYPICAL VERTICAL BACKDROP TO CATCHPIT CHAMBER DETAIL

(Note: Where the backdrop is not excessive a 45 degree drop pipe may be used)

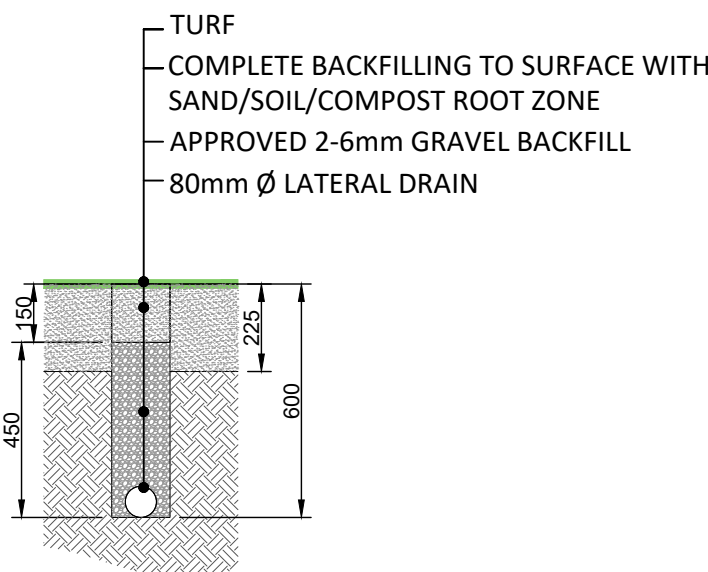

80mm LATERAL DRAIN DETAIL

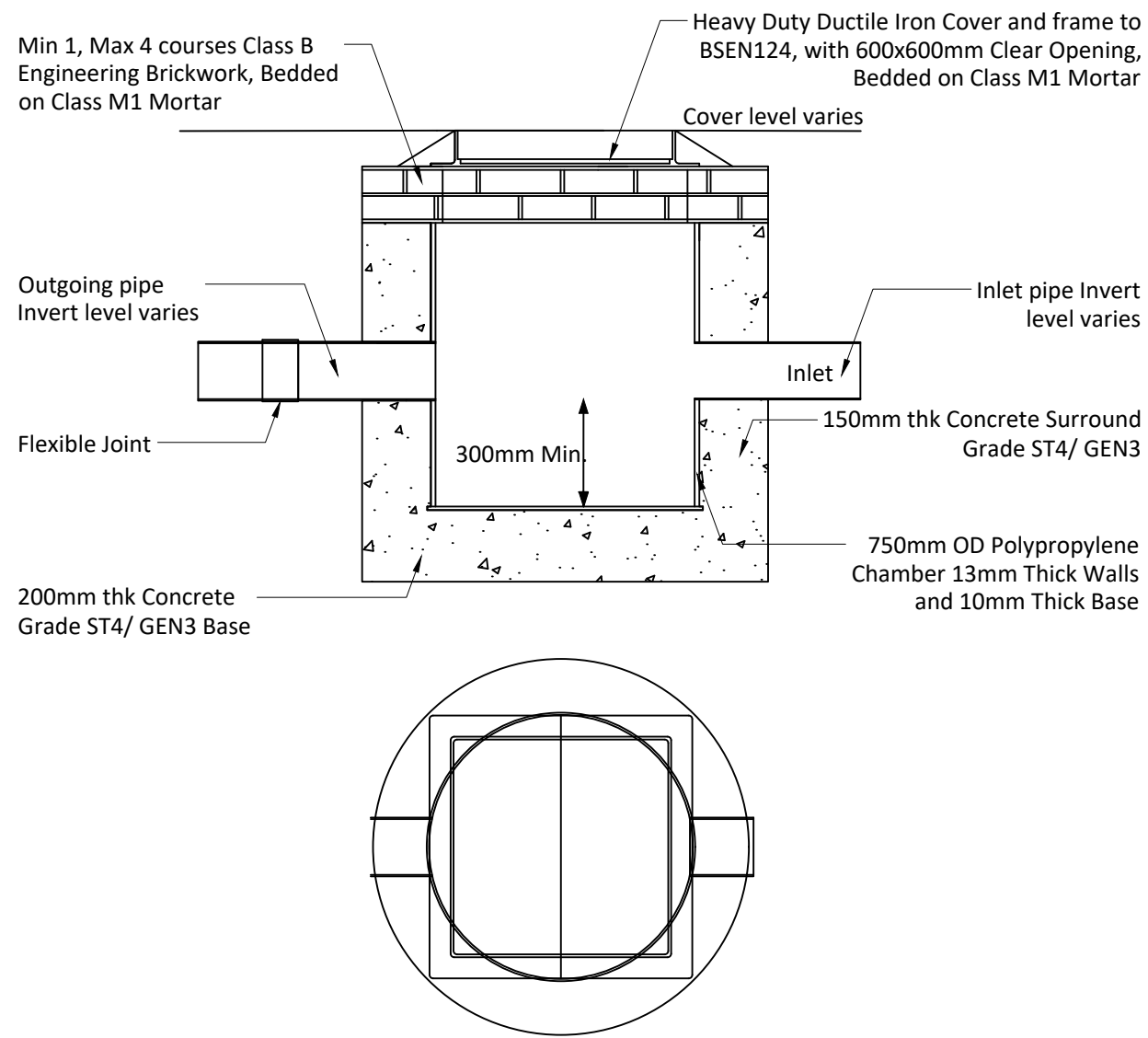

750Ø PERMAVOID CATCHPIT INSPECTION CHAMBER

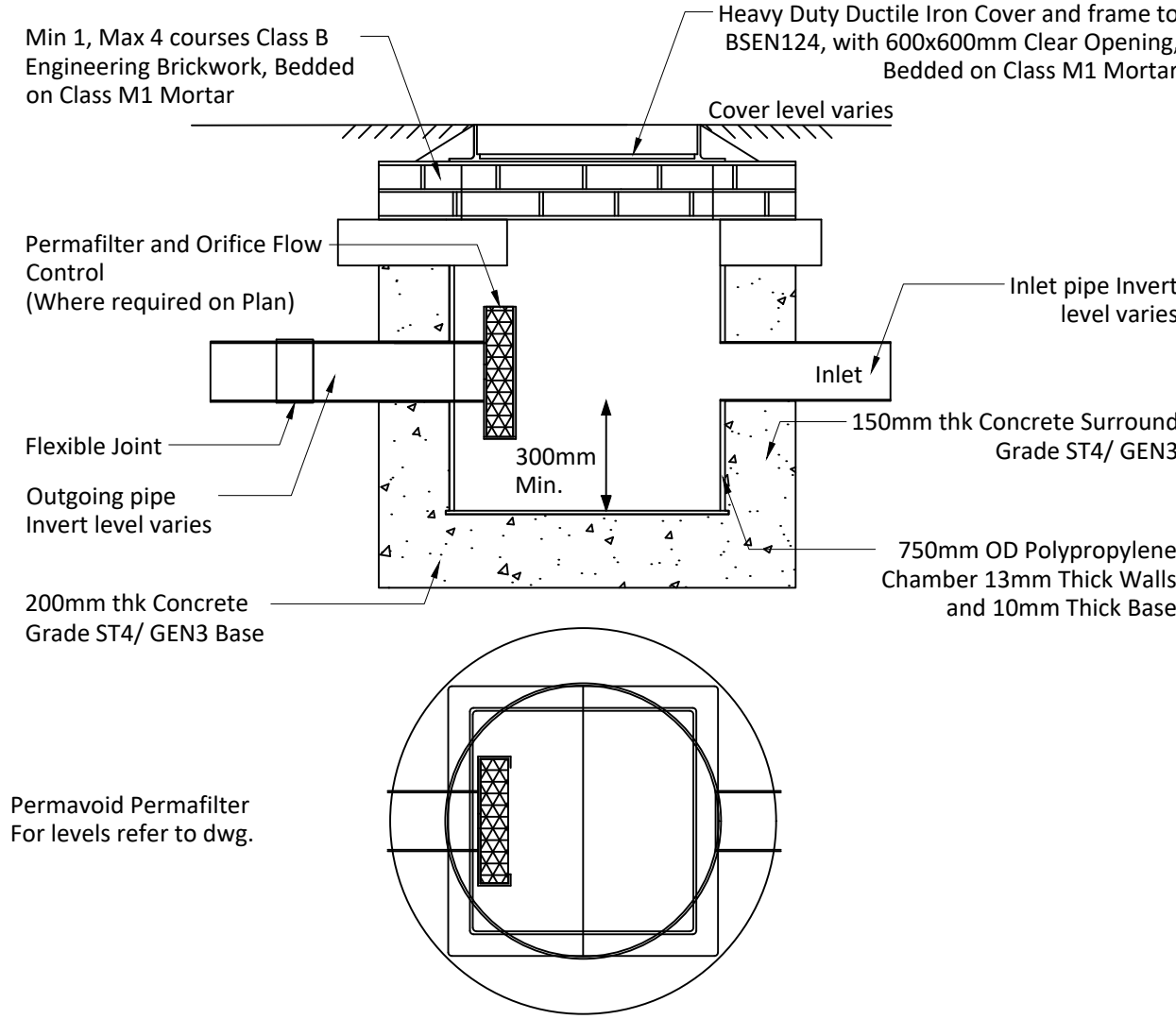

750Ø PERMAVOID CATCHPIT INSPECTION CHAMBER INCORPORATING FLOW CONTROL AND DEBRIS DEVICE (900Ø Similar)

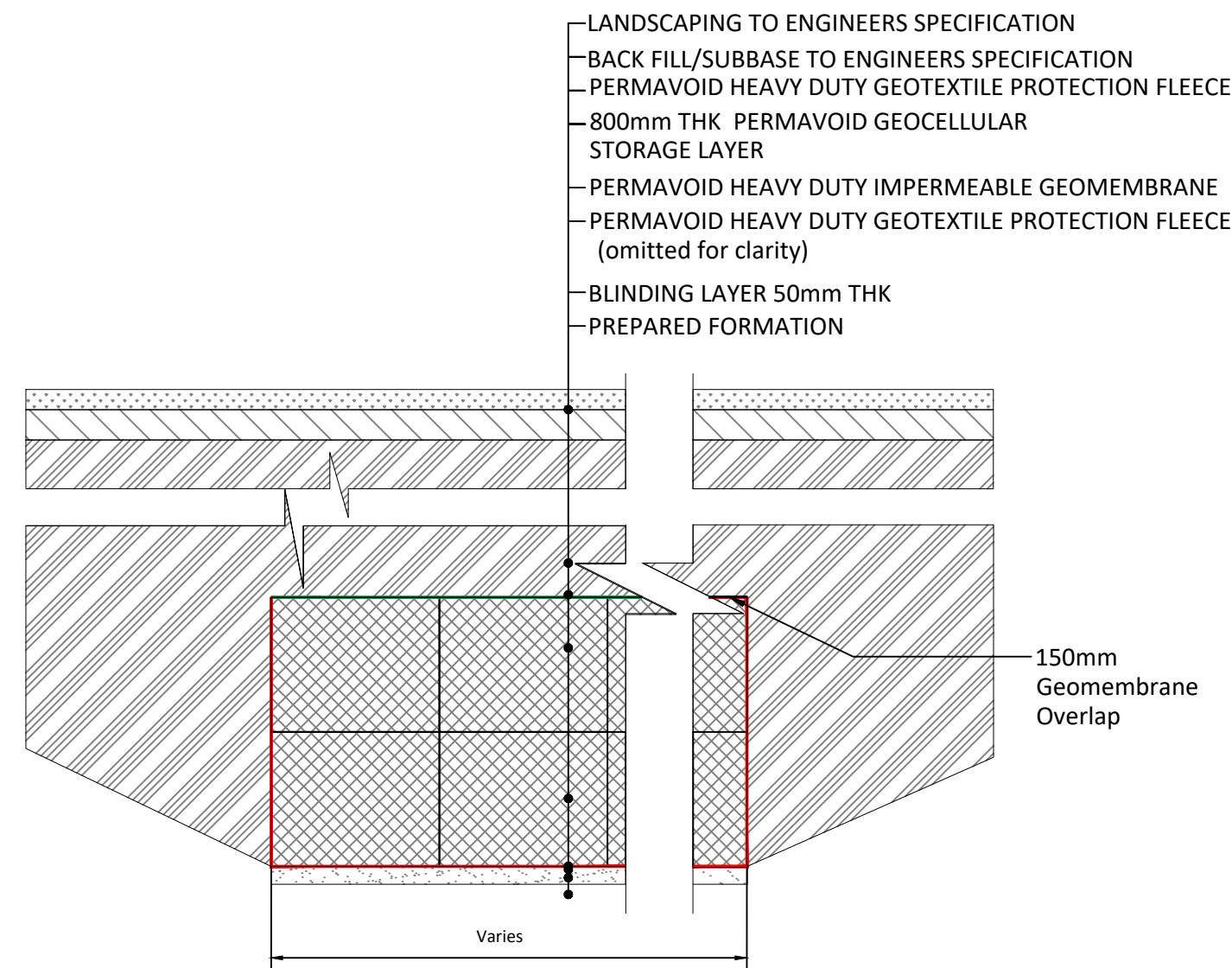

TYPICAL SECTION THROUGH 800 THK PERMAVOID ATTENUATION TANK

- Notes
1. Roadway and footpath surfacing design and construction to Engineer's Specification (by others).
  2. Heavy duty geotextile fleece to be non-woven needle-punched polypropylene as per Specification. Geotextile to be laid with minimum 300mm overlaps and to be applied to all external surfaces of Polypipe-Permavoid drainage units. To be installed in accordance with the manufacturer's recommendations.
  3. Waterproof geomembrane to be single layer cold applied robust welded flexible membrane as per Specification suitable for waterproofing to structures and for water containment. Membrane to be nominal 1mm thick laid with minimum 120mm laps and welded seams. To be installed in accordance with the manufacturer's recommendations under and approved CQA protocol that includes testing of the welds.
  4. All dimensions are in millimetres unless otherwise stated.
  5. Pre-cast concrete products shall comply with the relevant provisions of BS 5911 and be 'Kite Marked'.
  6. All pipes and pipe fittings shall be HDPE twinwall and have current British Board of Agreement Certification.
  7. Manhole covers and frames, grids and frames shall comply with the relevant provisions of BS EN 124.
  8. Do not scale from this drawing. If in doubt ask.
  9. This drawing to be read in conjunction with all relevant EPG, Architects & Engineers drawings.
  10. Should there be any conflict between the details indicated on this drawing and those on other drawings the Engineer should be informed PRIOR to construction on site.
  11. Until technical approval has been obtained from the relevant Authority, it should be understood that all drawings are PRELIMINARY and NOT FOR CONSTRUCTION.
  12. At all times the works are to be executed in accordance with the requirements of the Health And Safety at Work Act 1974 and CDM Regulations 2015.

REV	DESCRIPTION	DATE



PROJECT  
BARHAM PARK  
WEMBLEY

CLIENT  
STRI

DRAWING TITLE  
SUSTAINABLE DRAINAGE LAYOUT  
& DETAILS

SCALE	@A1	DATE
1:20		21/02/2020
DRAWN BY	CHECKED BY	STATUS
JHR	PC	FOR COMMENT
DRAWING No		REVISION
9091-EPG-ZZ-XX-DR-Y-0010		-