

## **TC 1107 - Berths 3, 4 & 5 Cathodic Protection – Port of Felixstowe**

### **Project Description**

The work for the cathodic protection (CP) to Trinity Berths 3, 4 & 5 includes the design, fabrication, installation, testing and commissioning of a galvanic (sacrificial) aluminium anode system to the seaward face steel sheet-pile wall and to the tubular king piles.

The work also requires the removal and disposal of the existing cathodic protection system, comprising brackets and anodes, which are now coming to the end of their effective life. The existing brackets may be retained if the Contractor opts to use them for the new CP system.

Trinity Berths 3, 4 & 5 main quay wall consists of the following four construction arrangements, on which all of the piles are uncoated.

1. Trinity I was completed in 1986 from Ch770m to 1319m. The quay wall construction consists of a Larssen 6 sheet-pile wall with 610mm tubular king piles generally at alternating 4200mm and 4800mm centres.
2. The 72m Extension was completed in 1988 from Ch1319m to Ch1391m. The quay wall construction consists of a Larssen 6 sheet-pile wall with 610mm tubular king piles generally at alternating 4200mm and 4800mm centres.
3. Trinity II was completed in 1990 from Ch1391m to Ch1706m. The quay wall construction consists of a Larssen 6 sheet-pile wall with 610mm tubular king piles generally at alternating 4200mm and 4800mm centres.
4. A length of the Trinity III construction completed in 1995 from Ch1706 to Ch 1847.38m. The quay wall construction consists of a Larssen 6 sheet-pile wall with 1420mm tubular king piles generally at 3000mm centres.

The existing CP system for Trinity Berths 3, 4 & 5 was installed in 2006.

It should be noted that an impressed-current CP system will not be acceptable and will not be considered by the Employer.

The Works entail the construction of all works associated with the above, which include, but may not be limited to, the following work elements;

- Anode and bracket design
- Anode and bracket casting/fabrication
- Diving
- Removal and disposal of existing anodes and brackets
- Bracket and anode installation
- Testing and commissioning of CP system

The value of the works are estimated to be £2.25M.

## Site Location

The Port of Felixstowe is located on the northern shore of Harwich Haven, at the mouth of the River Stour and River Orwell, approximately 80 miles north east of London.

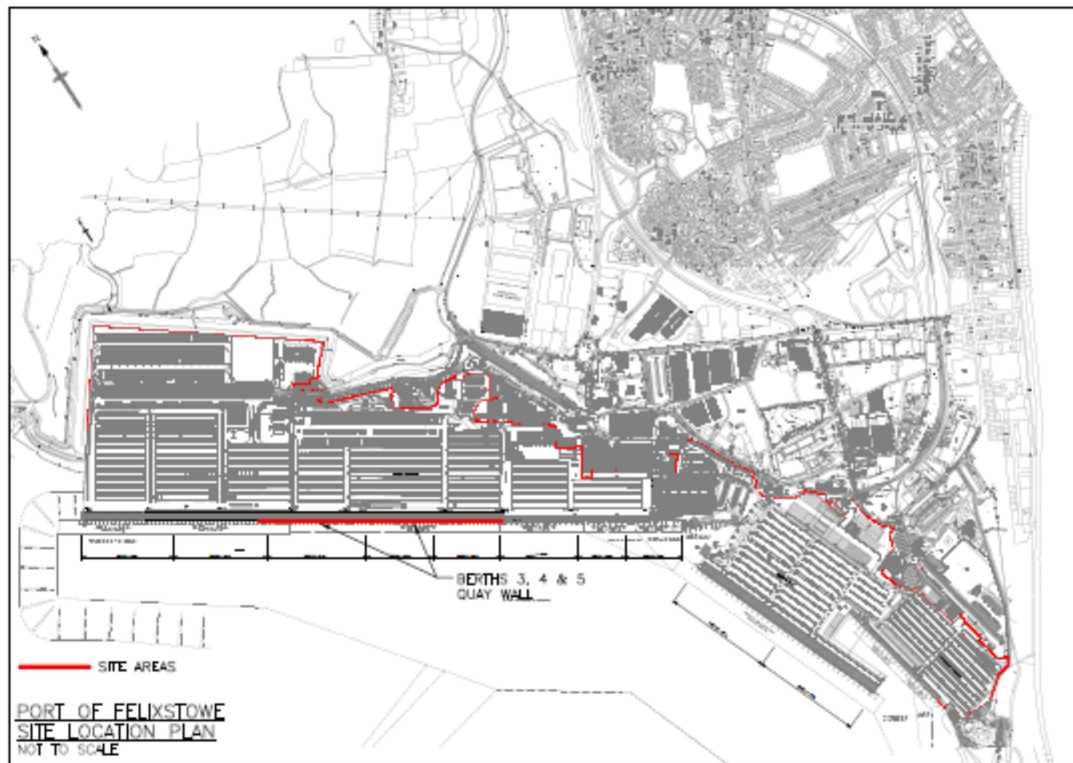

The site as shown above, highlighted in red, is located along the main quay wall as shown.

The Works shall be co-ordinated with the Port to suit vessel movements and berth occupancy. The Contractor will be expected to work on areas of the main quay wall as and when they are accessible and, as such, the Works will not necessarily progress in a systematic and linear manner.

## Key Dates

It is anticipated that the Contract award of the works will be made Q1 2020 with all design and construction to be completed by the end of Q4 2020.

The return date for this PQQ is midnight 6<sup>th</sup> August 2019.