

KEY

- FIRST AID ROOM
- GENTS
- LADIES
- DISABLED
- CLOAKROOM
- LIFT
- SECURITY
- STAIRS
- ESCALATOR
- BABY CHANGE
- FIRE EXTINGUISHER LOCATIONS
- FIRE HYDRANT AREA TO BE LEFT CLEAR
- FIRE ALARM CALL POINT
- EVACUATION CHAIR

SERVICE DUCT
Central Hall - 520mm Wide x
470mm Long x 400mm Deep

SERVICE DUCT
Exchange Hall - 550mm Wide x
1000mm Long x 390mm DEEP

NOT INCLUDED IN TENANCY

KEEP CLEAR

Floor Box containing 4 x 13amp power
sockets and data sockets

Floor Box containing 4 x 13amp power
sockets and AV connections

Arch Loading Capacities
Arch 3 to Arch 9 - 4 tonnes
Arch 10 to Arch 16 - 10 tonnes

Divide Wall
Wall 1 - To be used Arches 3-12
Wall 2 - To be used Arches 13-16

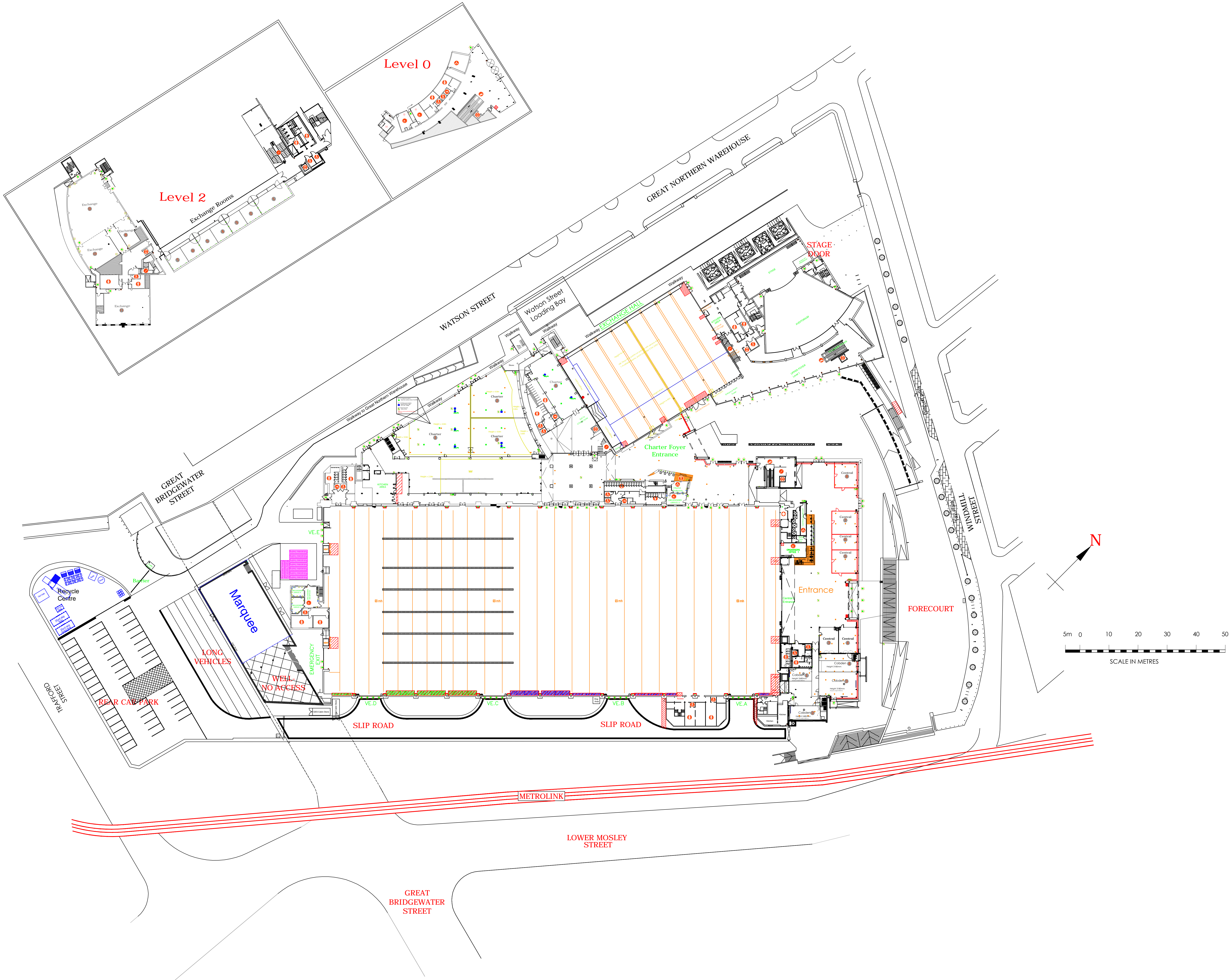

Manchester Central Convention Complex

CENTRAL HALL:
VEHICLE ENTRY DOORS A/B/C/D/E OPENING 7.3m WIDE x 5.05m HIGH
EXIT DOORS X/Y MUST BE LEFT CLEAR WHEN NUMBERS EXCEED:
CENTRAL 2: 5400 PEOPLE, CENTRAL HALL: 9600 PEOPLE
Floor loading is given as 1450kg/sqm, point loads of 7000kg are permissible
3m apart or at 2m distance from other distribution loads.
Vehicles up to 4000kg gross weight are permitted in the hall.
Loads & movements exceeding these limits must be verified in writing by
the hall management:
EXCHANGE HALL:
VEHICLE ENTRY DOORS OPENING 4.4m WIDE x 4.2m HIGH
Floor loading is given as 1450kg/sqm
Loads & movements exceeding these limits must be verified in writing by
the hall management:

Drawing: FS 11-12-17-001

This drawing is copyright to Manchester Central and is issued in confidence
for information only, it shall not, in part or in whole, be copied, reproduced,
transmitted in any form or disclosed to any third party, without the written
consent of Manchester Central.
NOTE:
All details & dimensions shown are indicative only and should be checked
on site for accuracy.

Manchester Central
Convention Complex
Petersfield
Manchester
M2 3GX
Tel 0161 834 2700
Fax 0161 833 3168 (operations)
Fax 0161 832 3621 (sales)
E-events@manchestercentral.co.uk
E-sales@manchestercentral.co.uk
W-www.manchestercentral.co.uk

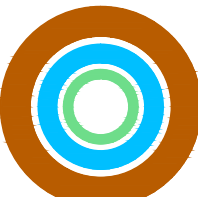

Manchester
Central