

Do not scale drawings
All dimensions are in millimetres unless stated otherwise
Use figured dimensions only and report any discrepancies in writing to the architect

Key			
	Below ground		Emergency voice communications panel
	Concrete blockwork		Aspirating smoke detection system control panel
	Reinforced concrete		Interface unit
	Evac Chair		Fire alarm panel
	Fire curtain		Short circuit isolator
	Illuminated fire exit sign		Junction box
	Directional fire exit sign		Disabled refuge outstation
			Magnetic door release
			Fire alarm horn sounder

General Notes:
- The fire strategy and associated equipment in the area of the Museum unaffected by the works (generally to the left of the 30 min fire compartmentation that separates the East Wing from the rest of the Museum) remains as existing
- Generally refer to services engineer's drawings and NBS specification for further information (type of emergency light fittings, etc)

	Wall mounted visual beacon
	Wall mounted fire alarm sounder
	Remote indicator for detection device
	Emergency light
	Smoke detector (photo optical or ionisation type) combined with visual beacon and sounder
	Heat detector (high temp fixed temperature) combined with visual beacon and sounder
	Fire alarm break glass unit
	Water fire extinguisher (9 litres)
	Carbon dioxide fire extinguisher (2 Kg)
	Foam fire extinguisher (9 litres)

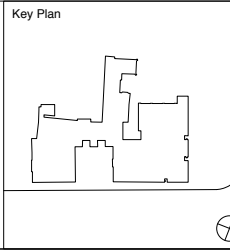

Maidstone Museum & Bentley Art Gallery East Wing Development	
Proposed First Floor Plan Fire Strategy Scale 1:100	
January 2009	
Draw N° 126/GA-52	Rev AB
Drawn by GR	Checked by
Size A1	
HUGHBROUGHTONARCHITECTS	
41a Beaver Lane, London W6 9EL	
T 020 8735 9959 F 020 8563 3891 E info@hbarchitects.co.uk	
AB	As Built Issue
C1	Construction Issue
T4	Revised BC Issue
T3	BC Issue
Rev	Description
GR	Drawn
19/10/11	Date
12/03/10	Date
18/10/09	Date
18/05/09	Date